

IES INDOOR REPORT
PHOTOMETRIC FILENAME : L09124505.IES

DESCRIPTION INFORMATION (From Photometric File)

IESNA:LM-63-2002
 [TEST] L09124505
 [TESTLAB] LIGHT LABORATORY, INC.
 [ISSUEDATE] 9/28/2012
 [MANUFAC] FULHAM
 [LUMCAT] FHEC31
 [LUMINAIRE] 12-1/4"L. X 18"W. X 5-1/4"H. EMERGENCY EXIT LIGHT
 [MORE] TWO 5.4W 6V INCANDESCENT LAMP WITH SPECULAR ALUMINUM LENS
 [MORE] PRISMATIC ACRYLLIC LENS
 [LAMPPOSITION] 0,0
 [OTHER] INDICATING THE CANDELA VALUES ARE ABSOLUTE AND
 [MORE] SHOULD NOT BE FACTORED FOR DIFFERENT LAMP RATINGS.
 [_POWER SUPPLY] 6.0VDC CONSTANT VOLTAGE SOURCE
 [_INPUT] 6.0VDC, 10.09W

CHARACTERISTICS

Lumens Per Lamp	N.A. (absolute)
Total Lamp Lumens	N.A. (absolute)
Luminaire Lumens	39
Total Luminaire Efficiency	N.A.
Luminaire Efficacy Rating (LER)	4
Total Luminaire Watts	10.09
Ballast Factor	1.00
CIE Type	Direct
Spacing Criterion (0-180)	0.26
Spacing Criterion (90-270)	0.26
Spacing Criterion (Diagonal)	0.30
Basic Luminous Shape	Rectangular
Luminous Length (0-180)	0.33 ft
Luminous Width (90-270)	0.85 ft
Luminous Height	0.00 ft

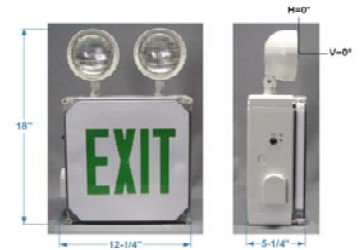

LUMINANCE DATA (cd/sq.m)

Angle In Degrees	Average 0-Deg	Average 45-Deg	Average 90-Deg
45	366	366	366
55	344	344	344
65	393	393	393
75	298	298	298
85	264	264	264

CANDELA TABULATION

	<u>0</u>
0.0	131.05
1.0	132.40
3.0	112.97
5.0	89.05
7.0	66.97
9.0	50.58
11.0	37.72
13.0	26.51
15.0	19.95
17.0	16.15
19.5	12.42
22.5	10.58
25.5	9.48
29.0	8.11
33.0	7.74
37.5	7.43
42.5	6.95
47.5	6.54
55.0	5.15
65.0	4.33
75.0	2.01
85.0	0.60
90.0	0.00

IES INDOOR REPORT
PHOTOMETRIC FILENAME : L09124505.IES

ZONAL LUMEN SUMMARY

Zone	Lumens	%Lamp	%Fixt
0-20	12.89	N.A.	32.80
0-30	17.13	N.A.	43.60
0-40	21.08	N.A.	53.60
0-60	29.98	N.A.	76.30
0-80	37.73	N.A.	96.00
0-90	39.31	N.A.	100.00
10-90	33.11	N.A.	84.20
20-40	8.19	N.A.	20.80
20-50	13.34	N.A.	33.90
40-70	13.39	N.A.	34.10
60-80	7.76	N.A.	19.70
70-80	3.26	N.A.	8.30
80-90	1.57	N.A.	4.00
90-110	0.00	N.A.	0.00
90-120	0.00	N.A.	0.00
90-130	0.00	N.A.	0.00
90-150	0.00	N.A.	0.00
90-180	0.00	N.A.	0.00
110-180	0.00	N.A.	0.00
0-180	39.31	N.A.	100.00

Total Luminaire Efficiency = N.A.%

ZONAL LUMEN SUMMARY

Zone	Lumens
0-10	6.19
10-20	6.70
20-30	4.24
30-40	3.95
40-50	5.15
50-60	3.75
60-70	4.50
70-80	3.26
80-90	1.57
90-100	0.00
100-110	0.00
110-120	0.00
120-130	0.00
130-140	0.00
140-150	0.00
150-160	0.00
160-170	0.00
170-180	0.00

IES INDOOR REPORT
PHOTOMETRIC FILENAME : L09124505.IES

COEFFICIENTS OF UTILIZATION - ZONAL CAVITY METHOD

Effective Floor Cavity Reflectance 0.20

RC	80				70				50			30			10			0
RW	70	50	30	10	70	50	30	10	50	30	10	50	30	10	50	30	10	0
0	120	120	120	120	117	117	117	117	112	112	112	107	107	107	103	103	103	101
1	110	105	101	97	107	103	99	95	98	95	92	94	92	89	91	89	87	84
2	101	93	86	81	98	91	85	80	87	82	78	84	80	76	81	78	75	73
3	93	84	76	70	91	82	75	69	79	73	68	76	71	67	74	69	66	64
4	87	76	68	62	85	75	67	61	72	66	61	70	64	60	68	63	59	57
5	82	70	62	56	80	69	61	56	67	60	55	65	59	54	63	58	54	52
6	77	65	57	51	75	64	56	51	62	55	50	61	55	50	59	54	50	48
7	73	61	53	47	71	60	52	47	58	52	47	57	51	47	56	50	46	44
8	69	57	49	44	67	56	49	44	55	48	44	54	48	44	53	47	43	42
9	66	54	46	42	64	53	46	42	52	46	41	51	45	41	50	45	41	39
10	63	51	44	39	61	51	44	39	50	43	39	49	43	39	48	43	39	37

POLAR GRAPH

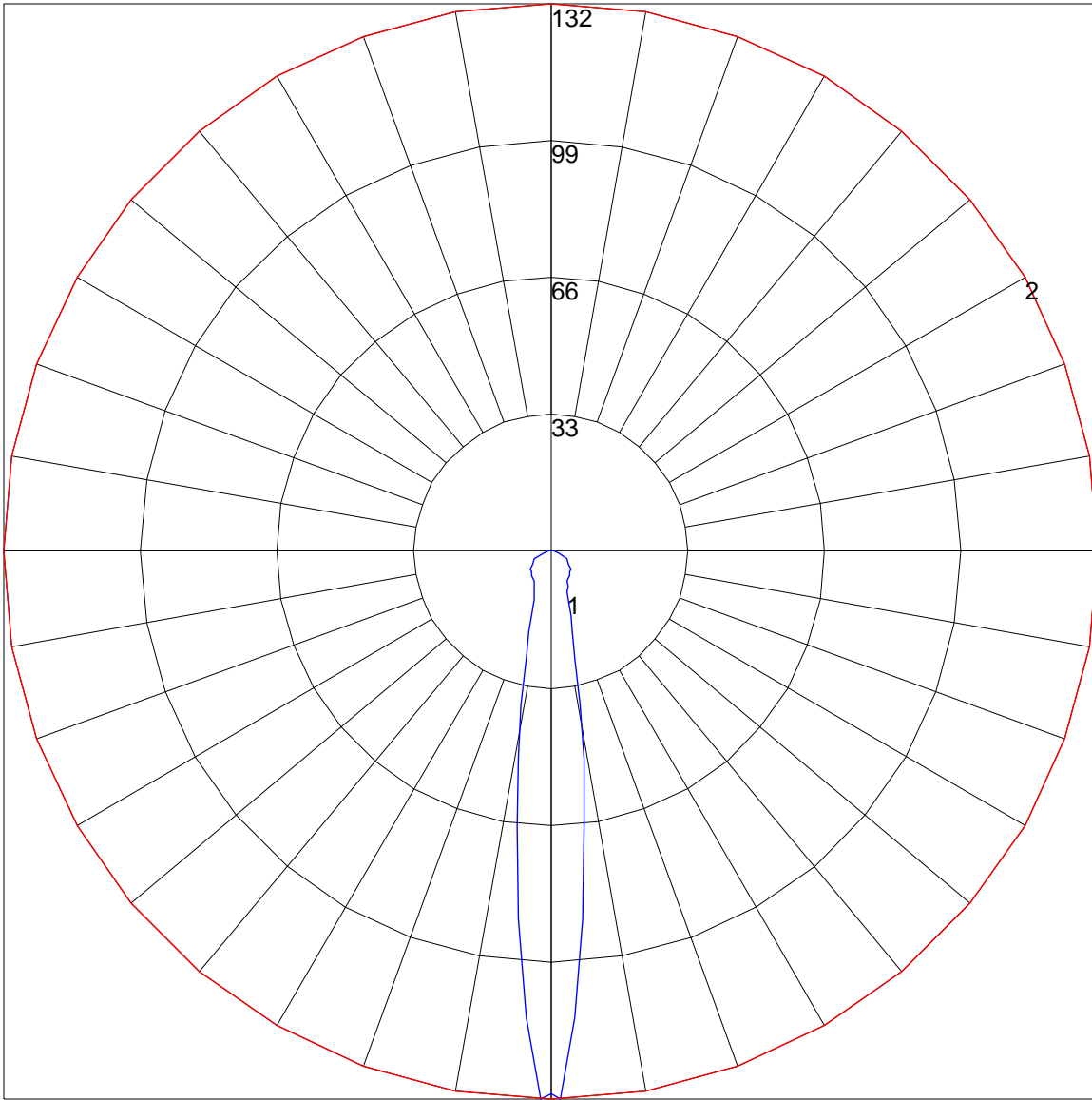

Maximum Candela = 132.4 Located At Horizontal Angle = 0, Vertical Angle = 1
1 - Vertical Plane Through Horizontal Angles (0 - 180) (Through Max. Cd.)
2 - Horizontal Cone Through Vertical Angle (1) (Through Max. Cd.)