

**SPECIFICATION SHEET : WHCG4-120-T8-IS**

This Is An Original Product From Fulham Co., Inc

**Description : WORKHORSE Specifier Grade Series Electronic Ballast, Drop In Replacement for Magnetic Ballast, Parallel Lamp Operation, THD Less Than 10%**

**This Ballast Will Operate Following Lamps.**

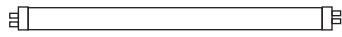

**F17T8 / F25T8 / F32T8 / F40T8**  
**F32T8/30W, F32T8/28W, F32T8/25W**

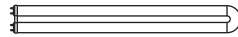

**FBO31T8**

**ELECTRICAL DATA**

LAMP WATTS / TYPE	F40T8	F17T8	F25T8	F32T8	F40T8	FBO31T8	F32T8/30	F32T8/28	F32T8/25	F17T8	F25T8	F32T8	FBO31T8	F32T8/30	F32T8/28	F32T8/25
LAMPS OPERATED	2				3						4					
INPUT WATTS	88.81	50.68	70.53	91.20	115.60	88.87	85.73	78.44	73.42	60.29	84.18	109.60	106.60	103.00	94.14	88.04
LINE CURRENT	0.752	0.429	0.593	0.765	0.969	0.746	0.720	0.659	0.618	0.517	0.713	0.924	0.899	0.870	0.796	0.745
POWER FACTOR	0.98	0.98	0.99	0.99	0.99	0.99	0.99	0.99	0.99	0.97	0.98	0.99	0.99	0.99	0.99	0.98
BALLAST FACTOR	1.08	0.98	0.91	0.91	0.96	0.94	0.94	0.93	0.99	0.91	0.87	0.65	0.86	0.86	0.85	0.91
EFFICACY FACTOR	1.22	1.93	1.29	0.99	0.83	1.06	1.10	1.18	1.35	1.51	1.03	0.59	0.81	0.84	0.90	1.04
THD	8.6%	7.9%	7.9%	8.3%	9.0%	8.3%	8.2%	8.0%	8.4%	8.3%	8.5%	8.8%	8.5%	8.7%	8.4%	8.4%
CURRENT CREST FACTOR																
EM/RFI COMPLIANCE	FCC PART 18A (NON-CONSUMER)															
SOUND RATING	"A"															
BALLAST TYPE	INSTANT START															
VOLTAGE TRANSIENTS	ANSI C82.11 - 1993															
INPUT PROTECTION	FUSE															
OUTPUT PROTECTION	-															
MIN STARTING TEMP	- 18°C (0°F)															
MAX CASE TEMP	70°C (158°F)															
TYPE "H" APPROVAL	APPROVED FOR HAZARDOUS LOCATION															
ENERGY STAR 4.0	-															
APPROVALS / CLASS	UL/UL LISTED, CLASS "P", 1 OUTDOOR															

**MECHANICAL DATA**

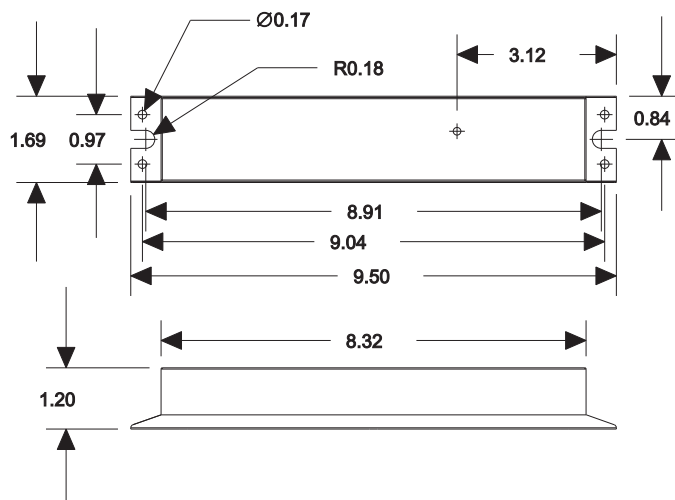

Where : L = Length, W = Width, H = Height

**WIRING DIAGRAMS**

WIRE	BLACK	WHITE	RED	BLUE	YELLOW	BROWN
LENGTH - INCHES	28 ± 1"	28 ± 1"	30 ± 1"	30 ± 1"	46 ± 1"	

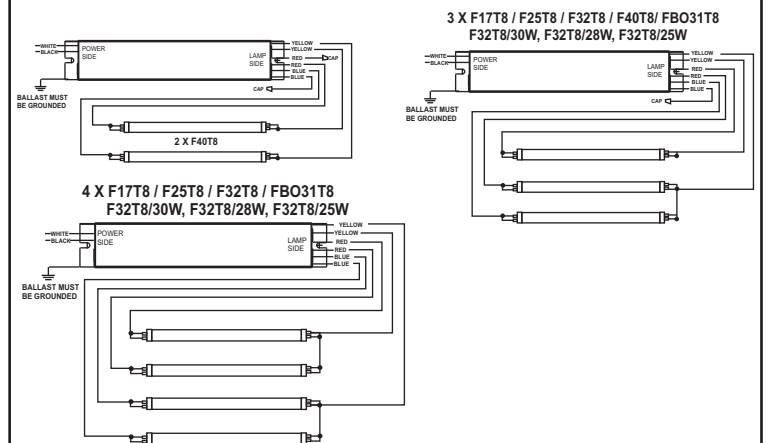

**NOTE : This Ballast Case Must Be Grounded**

Fulham extends a limited warranty only to the original purchaser or to the first user for a period of 5 years from the date of manufacture when properly installed and operated under normal conditions of use. For complete terms and conditions, please reference the Fulham product catalog ([www.fulham.com](http://www.fulham.com))  
 Due to a program of continuous improvement, Fulham reserves the right to make modifications or variations in design or construction to the equipment described.