

## SPECIFICATION SHEET: **T1T11200350-17CB**

This Is An Original Product From Fulham Co., Inc

RoHS  
COMPLIANT

IP64

**Description:** LED Driver, One channel, Triac dimming, 120V, CC, 350mA, 17W, Compact with wire

### This Driver Will Operate The Following LED Modules:

Any LED module designed to accept constant input current of 350mA and has a forward input voltage range of 26-49VDC.

### ELECTRICAL DATA

Input Voltage	120VAC, 60Hz
Input Current	0.19A
Input Power	22W
Power Factor	>0.95 at full load (without dimmer)
THD	≤20% at full load (without dimmer)
Efficiency	>80%
Driver Type	Constant Current
Output Current	350mA
Output Voltage Range	26-49VDC
Output Power	17W
Number of Output Channels	1
Dimming Controller Type / Dimming Range	Phase Control / 100%-10%
RFI/EMI	FCC PART 15B CONSUMER
Output Type	Class 2
Ambient Operating Temperature Range	-40°C to 60°C
Max. Case Temperature	90°C
Sound Rating	A
Input Surge Protection	Line-Neutral 1kV, Line & Neutral-Ground 2kV
Protections	Input Current Protection
	Output Short Circuit Protection
	Output Open Circuit Protection
	Output To Ground Short Protection
	Overload Protection
Triac Dimmers	Support almost 90% of the Triac Dimmers on the market. Such as below list.
	Leviton IPI06-1LM
	Leviton VPI06-1LT
	Lutron DV-600P
	Lutron MAW-600H
	Lutron S-603PR-**
	Lutron DV603PG
	Lutron LG-603P
	Lutron LG-600P
	Leviton 663 1-L-*
	Leviton 6681 -*
	Lutron S-600P
	Lutron TG-600P
	Leviton IP110
	Leviton 6161
	Pass & Seymour D703-PLAV
Service Life	5 Years @ Tc 85°C
Approvals / Class	cURus Class 2, Type CC, Type HL/TL, Dry or Damp Locations; RoHS; IP64

Fulham extends a limited warranty only to the original purchaser or to the first user for a period of 5 years @ Tc 85°C from the date of manufacture when properly installed and operated under normal conditions of use. For complete terms and conditions, please reference the Fulham Product Catalog ([www.fulham.com](http://www.fulham.com)). Due to a program of continuous improvement, Fulham reserves the right to make modifications or variations in design or construction to the equipment described. © Fulham Company Limited, All Rights Reserved.

**SPECIFICATION SHEET: T1T11200350-17CB**

This Is An Original Product From Fulham Co., Inc

RoHS  
COMPLIANT

**IP64**

**Description:** LED Driver, One channel, Triac dimming, 120V, CC, 350mA, 17W, Compact with wire

**This Driver Will Operate The Following LED Modules:**

Any LED module designed to accept constant input current of 350mA and has a forward input voltage range of 26-49VDC.

**MECHANICAL DATA**

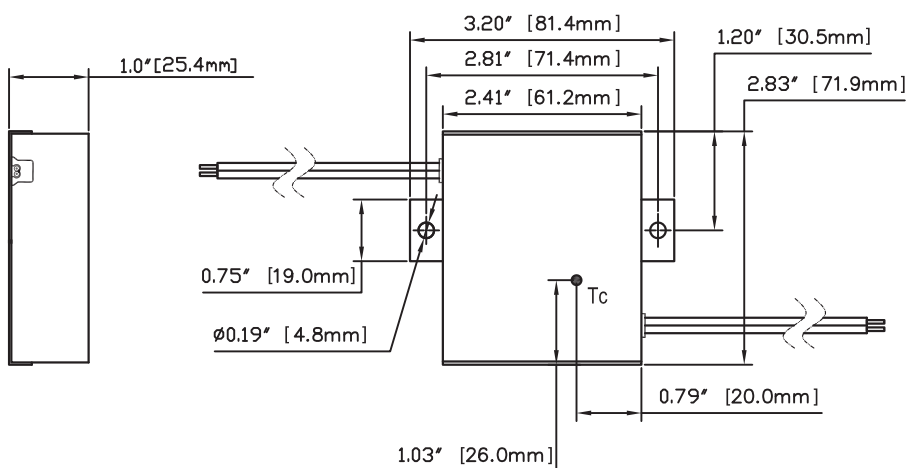

Where : L = Length, W = Width, H = Height, Tolerance=±0.02"

**WIRING DIAGRAMS**

INPUT SIDE	LENGTH	OUTPUT SIDE	LENGTH
BLACK	8"[203.2mm]	RED	8"[203.2mm]
WHITE	8"[203.2mm]	BLUE	8"[203.2mm]

