



T1M1UNV140P-40C

IP20 

Programmable Constant Current

- Input Voltage: 120V - 277VAC 50/60Hz
- Output Current Range: 470mA - 1400mA
- Output Voltage Range: 10V - 54VDC \equiv
- Output Power: 40W Max.
- 0-10V Dimming
- Dimming Range: 100% -1%, 0% (Dim-to-Off)

General Specifications

Input Voltage / Frequency	120V - 277VAC 50/60Hz \pm 10%
Input Current	0.42A @120V, 0.22A @240V and 0.19A @277V
Input Power	47W
Power Factor	> 0.9 under 120~277Vac input with 80~100% load condition (for all output currents)
THD	< 20% under 120~277Vac input with 80~100% load condition (for all output currents)
Efficiency	86% @120V, 87% @240V, 88% @277V
Inrush Current	20A @277V
Leakage Current	Maximum 0.5mA at 277Vac, 60Hz input
Open Circuit Voltage	60V
Driver Type	Constant Current
Programming Type	Wireless, TPSB-100AW NFC Digital Wand
Output Voltage Range	10VDC - 54VDC \equiv
Output Current Range	470mA - 1400mA (programmable in 10mA increments)
Output Power	40W Max.
Aux Output	12V/200mA Max.
Load Regulation	\pm 2%
Line Regulation	\pm 1%
Current Tolerance	\pm 5% at full load condition
Turn-on Delay Time	< 0.75s at full load condition
Overshoot	< 10% at full load condition
No Load Power Consumption	< 1W
Ripple & Noise (pk-pk)	< 3%
Withstand Voltage	I/P – O/P, 2,800Vdc, 2mA
Dimming Type	0-10V Dimming
Dimming Range	100% -1%, 0% (Dim-to-Off)
Operating Ambient Temperature Range	-40 ~ 50°C
Storage Temperature	-40 ~ 85°C
Maximum Driver Case Temperature (Tc)	90°C
Humidity	5% to 95%
Driver Output Type / Number of Output Channels	LED Class 2 / 1 Channel
Overall Size	5.00" L x 2.39" W x 0.99" H (127 x 60.6 x 25mm), Mounting 4.62"(117.4mm)
Weight	0.61lbs (0.28kg) / Unit
Case Construction	Metal
Input / Output Connector Type	I/P: 18 AWG x 2C (30cm) ; O/P: 22AWG x 2C (30cm) ; connector
Safety / Compliance	UL8750, Class P, Type HL Suitable for Dry and Damp locations
IP Rating	IP20
EMC	FCC, 47CFR Part 15; ANSi C63.4:2009 Class B (Consumer Limit)
Protections	Over Voltage Protection Over Current Protection Short Circuit Protection Over Temperature Protection
Service Life	85,000 hours lifetime @ Tc 60°C
Warranty	5 years @ Tc 60°C from the date of manufacture

T1M1UNV140P-40C

IP20 

Charts

Figure 1

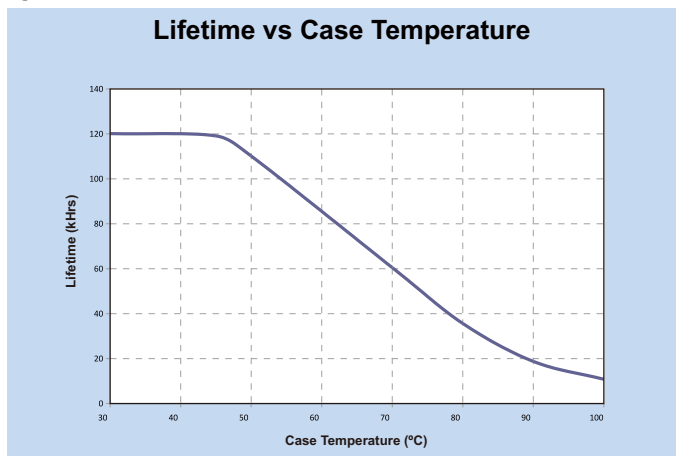

Figure 2

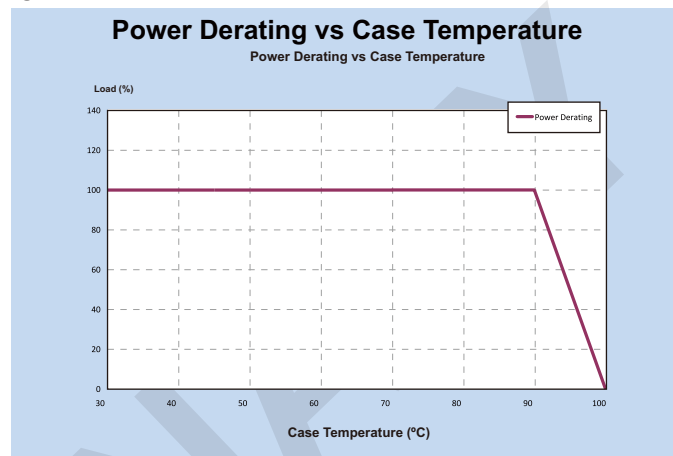

Figure 3

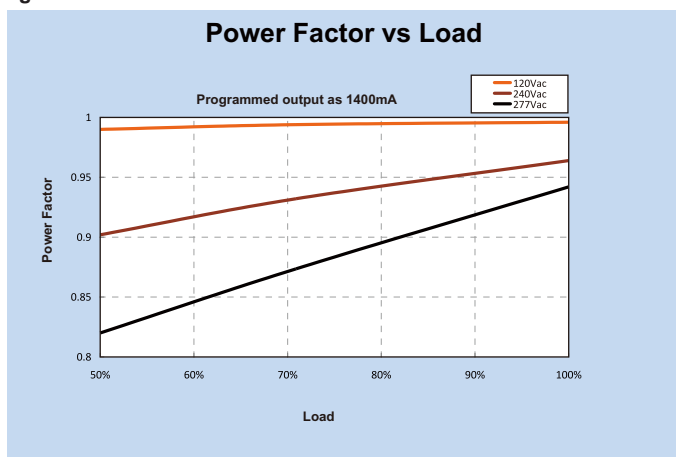

Figure 4

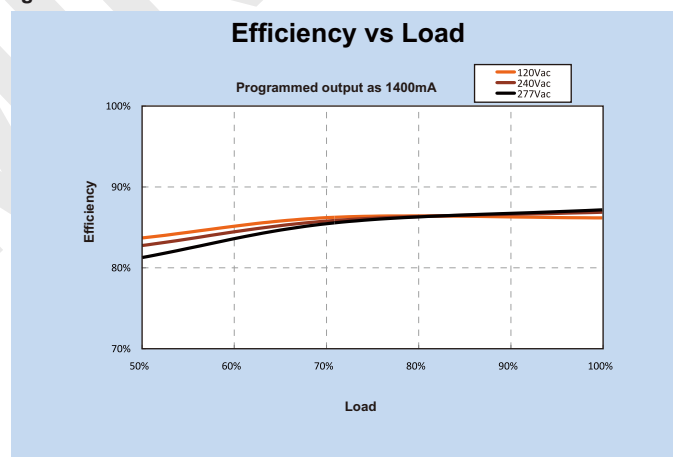

Figure 5

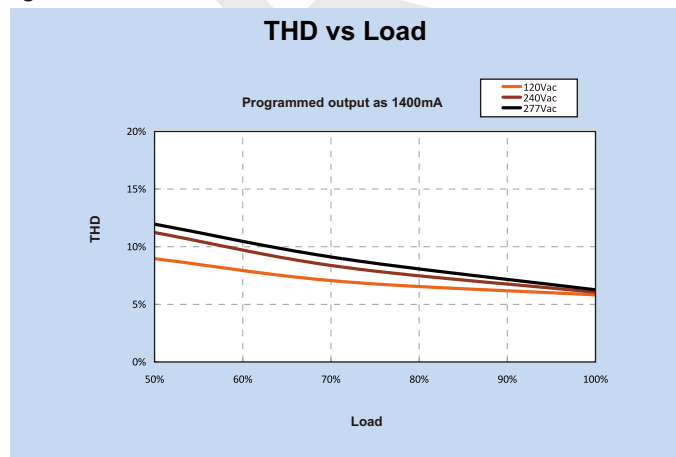
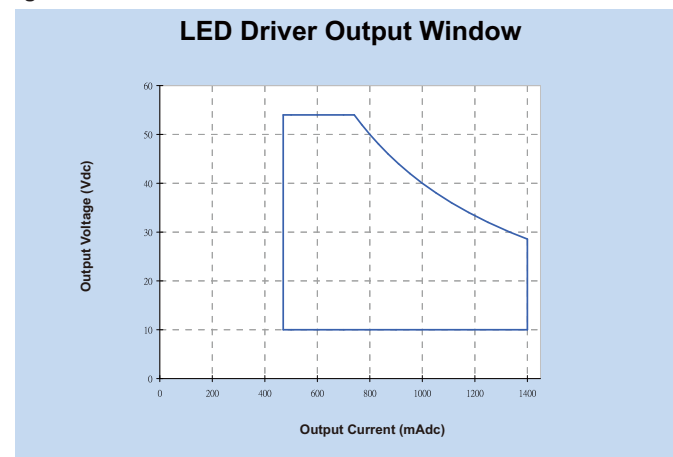

Figure 6





T1M1UNV140P-40C

IP20 

Mechanical Drawings

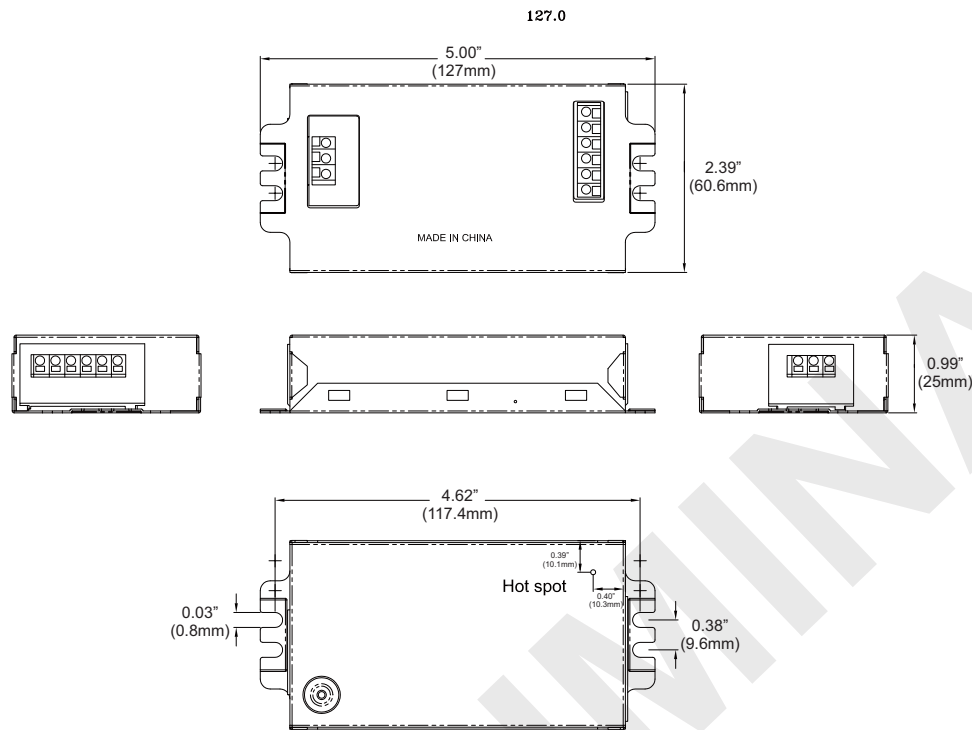

Overall Dimensions	
Length	5.00" [127mm]
Width	2.39" [60.6mm]
Height	0.99" [25mm]
Mounting	4.62" [117.4mm]
Wire Length	
Input/ Output	Terminal Block
0-10V Dimming	Terminal Block"

Wire Diagram

Ground	Green	Blue	VO (-): LED load, negative (-)
Neutral	White	Red	VO (+): LED load, positive (+)
Live	Black	Orange	BTIN: N/C
		Yellow	Aux 12Vdc (+): Auxiliary 12Vdc output, positive (+)
		Grey	RTN: Dimming and auxiliary output, negative (-)
		Purple	Dimming (+): Dimming, positive (+)
		NFC ANTENNA	••) NFC

NOTES :

- 1) This driver must be installed by a licensed electrician
- 2) This driver must be grounded

T1M1UNV140P-40C

IP20 

Guidelines

Grounding

- Driver must be grounded by means of the Driver case.

Over temperature protection

- The Fulham ThoroLED drivers is protected against thermal overload. If the temperature limit is exceeded, the output current is reduced.

LED load

- Fulham ThoroLED drivers are designed to drive passive LEDs, -COB's and -LED assemblies .Proper function is not guaranteed when (LED)loads with active components are used.

Short-circuit protection

- In case of a short circuit the LED driver switches to protection mode. After the removal of the short-circuit the LED driver will recover automatically.

No-load Operation

- In no-load operation the output voltage will not exceed the specified open circuit output voltage.

Hot Swapping

- This driver does not support hot swapping of the LEDs.

Remote Mounting

- Up to 26ft with 18AWG. Contact Fulham for higher remote distance.

Service life/Lifetime

- Failure Rate Info based upon MTBF modeling: 90% survivals at end of life @ $\leq T_c$ lifetime rating.

Warranty

- Reference Fulham's limited Warranty: <https://cdn.fulham.com/PDFs/Limited-Warranty.pdf>

T1M1UNV140P-40C

IP20 

Programing Tool

- 1) To program this LED driver use the Fulham TPSB-100AW NFC Digital Wand.
- 2) Please consult the user manual for instructions on using the TPSB-100AW FC Digital Wand.

Note: The LED driver can only be programmed in 10mA increments.



Toggle switch on side
Upward: Easy Mode
Downward: Advanced Mode

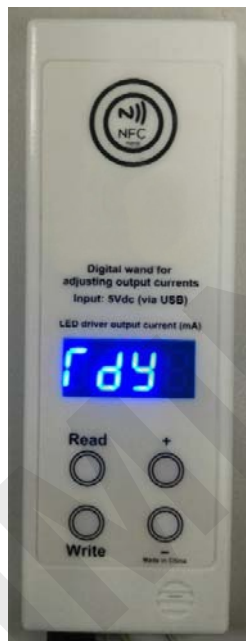

Ready State
Of
Advanced Mode



Program State
Of
Advanced Mode



T1M1UNV140P-40C

IP20 

Part Number Matrix

<u>T</u>	<u>1</u>	<u>M</u>	<u>1</u>	<u>UNV</u>	<u>140</u>	<u>P</u>	<u>40</u>	<u>L</u>
<u>LED Driver</u>	<u># of Control Channels</u>	<u>Dimming Control Type</u>	<u># of Control Channels</u>	<u>Input Voltage</u>	<u>Output Current</u>	<u>Characteristic</u>	<u>Max. Output Power</u>	<u>Case Type</u>
T = ThoroLED	1 = 1 Channel	M = 0-10V	1 = 1 Channel	UNV = 120V~277V	140 = 1400mA Max.	P = Programmable	40 = 40W	L = Long

Product Image



Packaging

Master Carton

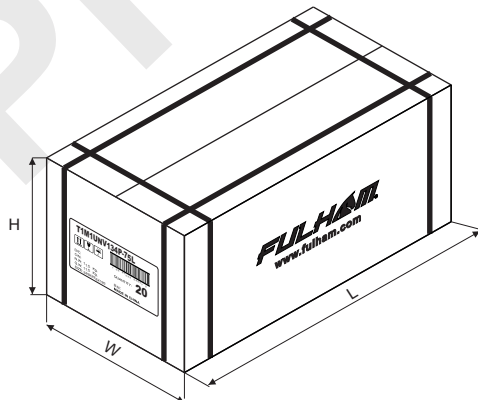

OUTER DIMENSION		
L	W	H
15.35"(390mm)	5.51"(140mm)	6.29"(160mm)
Net Weight	Gross Weight	QUANTITY
13.86 lbs. (14 kg)	33.06 lbs. (15 kg)	50pcs.