

**Discontinued**  
Contact Fulham for availability. Not for use in new designs.



## SB05 Induction Shoebox Series



PROFILE INDUCTION GENERATOR

TUBULAR INDUCTION  
300W

MOUNTING HEIGHT  
20' TO 40'

DIMMING WATTAGES  
TUBULAR 300W



The **SB05 Induction Shoebox Series** can be used in a variety of applications including billboard, parking lots, area lighting, tennis courts, scenic lighting, and industrial environments. Optimized for heights of 20ft to 40ft. SB05 Series has a fully adjustable mounting bracket, this allows the light to be aim and directed where it's needed. The die cast aluminum housing provides a superior corrosion resistance. Dual Induction systems allows for bi-level dimming. The Induction system operates well in cold temperatures with an instant ON/re-strike capability. The long life and superior lumen maintenance of Induction significantly reduces maintenance costs and provides a significant reduction in the total cost of ownership.

**APPLICATION -**

- Billboard
- Parking Lots
- Area Lighting
- Intended use for Replacements of HID Luminaries of Area Lighting

- Tennis Court
- Scenic Lighting
- Industrial Applications

**CONSTRUCTION -**

- Die Cast Aluminum Housing
- Corrosion Resistant
- Low Profile Design
- Standard Powder Coated Finish: Dark Bronze

- Flat Tempered Glass Lens
- Gas-tight Silicon Rubber Seal
- Slip Fitter Round Pole (Standard)
- Optional: Swivel Bracket

**ELECTRICAL -**

- Universal Voltage (120V – 277V)
- High Power Factor (>.95)
- Ambient Temperature Rating: -20°C to 40°C
- Input Frequency: 50/60 Hz
- Operating Frequency: 250 kHz
- Generator Type: Class P Type 1 outdoor
- THD %: < 10%

- Constant Wattage Output With Less Than 3% Variance
- No Variation Over a Wide Range of Temperatures and Voltage Fluctuation
- Instant On
- No Noise Compare to HID Systems
- Bi-Level Dimming
- Pre-Wired Output Connector (Plug and Play)

**LAMP TYPE/WATTAGES -**

- Tubular Induction Lamps Available: 300W (2 x150W)
- Standard Kelvin Temperature is 5000K: Provides a Cooler Color Temperature
- Wide Range of Color Temperature Options 2700K – 6500K Available
- CRI>80

- Pre-Wired Input Connector
- Low Lumen Depreciation, >70% Lumen Maintenance at 60,000 Hours
- Vibration and Shock Resistant: No Filament

**COMPLIANCE -**

- UL listed – UL 1598 (E363375)
- cUL listed – UL 1598 (E363375)
- FCC Part 18-A

- IP65: Suitable for Wet Location
- Surge Immunity – IEC 61000-4-5: Class 4

**DIMMING INDUCTION GENERATOR SPECIFICATIONS -**

- Dimming interface is electrically isolated for safety and reliability
- Dimmable Induction generator can work as a regular generator to drive the lamp at full range when the 0-10V interface is not connected.
- The output wattage is about 50% at 0-3VDC.
- The output wattage is dimmed from 100% to 50% at the 9-3VDC.
- Dimming wires: Violet (+), Gray (-)
- The output wattage is 100% at 9-10VDC.

- The output wattage is at the 100% range when the system is power ON. If the system is set on a dim level then it will dim within 30 seconds.
- Shorting the two dimming wires (Violet and Gray) sets the system to the lowest dim level of 50%, acting as a bi-level dimming system.

**OPTICS -**

- Specular Polished Surface Reflector Finish
- Precision Formed Anodized Reflector

- Clear Tempered Glass Lens
- Type V Distribution

**WARRANTY -**

- Five-year Limited Warranty

Actual performance may differ as a result of end-user environment and application.  
Note: Specifications subject to change without notice.

*NOTE:*  
1 Consult with your sales representative for availability.  
2 Consult with your sales representative for lead time.  
3. Dimming Generator, No Sensor included

### ORDERING OPTIONS

*Lead times will vary depending on options selected. Consult with your sales representative.*

| TYPE         | SERIES         | LAMP        | WATTAGE    | LENS     | MOUNTING   | ORDERING OPTIONS  |
|--------------|----------------|-------------|------------|----------|--|---|
| SB = SHOEBOX | 05 = 05 SERIES | T = TUBULAR | 300 = 300W | G= GLASS | I = SLIPFITTER (ROUND POLE)<br>V = SWIVEL BRACKET <sup>1</sup> | M = 0-10V Dimming <sup>3</sup><br>BLANK = 5000K<br>27 = 2700K<br>30 = 3000K<br>40 = 4000K<br>60 = 6000K<br>65 = 6500K |

**Example:** SB-05-T300-G-I (Shoebox 05 series Tubular 300W lamp with Glass lens and Slipfitter Bracket)

### ACCESSORIES

| DESCRIPTION:          | PART NUMBER:     |
|-----------------------|------------------|
| STEP DOWN TRANSFORMER |                  |
| 250W-400W             | HH-ILS-SD3-460VA |

**Discontinued**  
Contact Fulham for availability. Not for use in new designs.



### ELECTRICAL CHARACTERISTICS

| MODEL NO.                          | RATED WATTAGE (W) | INPUT POWER (W) | INPUT CURRENT 120V - 277V (AMP) | LAMP RATED INITIAL LUMINANCE (LM) | EFFICACY (LM/W) | LUMEN MAINTENANCE | COLOR RENDERING INDEX | CCT (KELVIN) |
|------------------------------------|-------------------|-----------------|---------------------------------|-----------------------------------|-----------------|-------------------|-----------------------|--------------|
| SB05-T300-G-I/M<br>SB05-T300-G-V/M | 300               | 315             | 2.63 - 1.14                     | 27000                             | 80 - 85         | 70%-75%           | > 80                  | 5000         |

### Mechanical Data

#### SLIP FITTER (ROUND POLE)

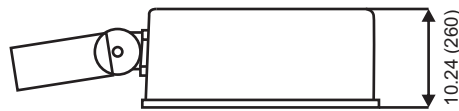

SIDE VIEW

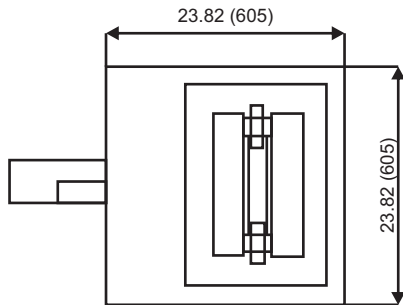

BOTTOM VIEW

#### SWIVEL BRACKET (OPTIONAL)



SIDE VIEW

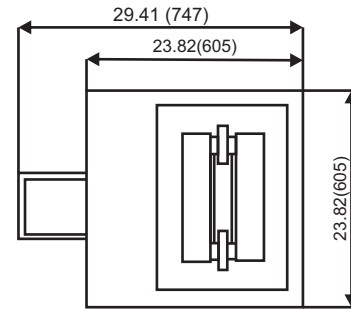

BOTTOM VIEW

#### SLIPFITTER (ROUND POLE)

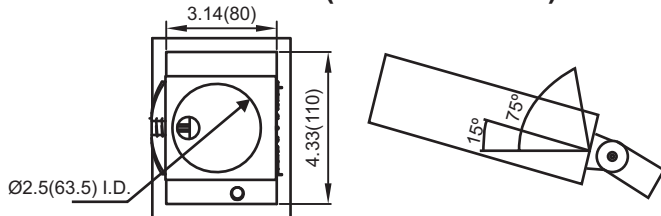

Recommended for 2" (50mm) pipe [2.375" (60mm) O.D.]

#### SWIVEL BRACKET

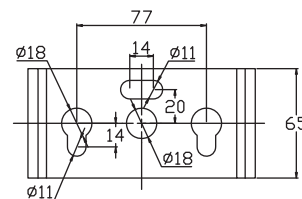

(Cord Length : 10")

All dimensions are shown in inches (millimeters) unless otherwise noted.

**Photometric Data**

IES files available upon request.

**POLAR GRAPH**

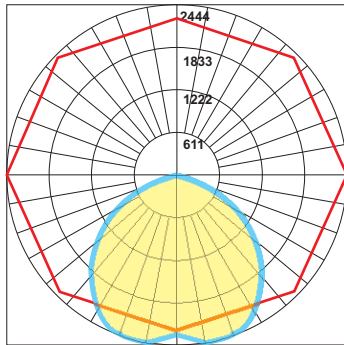

**SB05-T300-G/M**

**ILLUMINANCE AT DISTANCE**

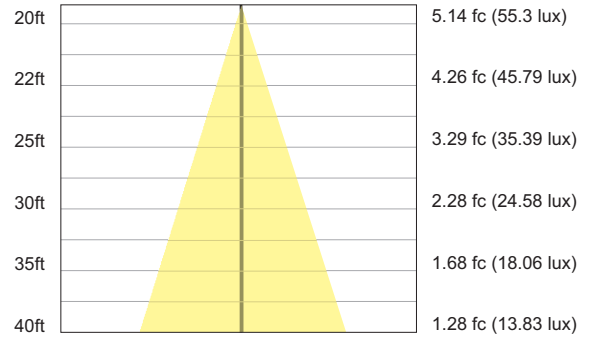

**SB05-T300-G/M**

Located At Horizontal Angle = 0, Vertical Angle = 12.5  
 # 1 - Vertical Plane Through Horizontal Angles (0 - 180) (Through Max. Cd.)  
 # 2 - Horizontal Cone Through Vertical Angle (12.5) (Through Max. Cd.)