

# Basic Collection

SHOEBOXES

**Discontinued**  
Contact Fulham for availability. Not for use in new designs.



## SB02 Induction Shoebox Series

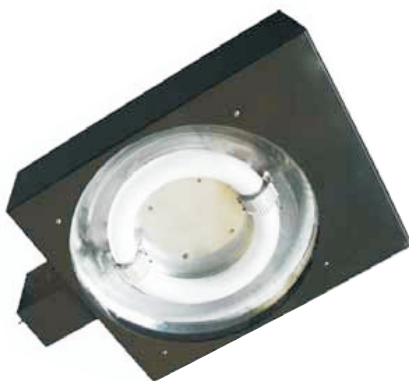

The **SB02 Induction Shoebox Series** can be used in a variety of applications including parking lots, tennis court, public areas, and dealerships. Optimize for heights of 12ft to 40ft. SB02 Series is available in two mounting options. Squared welded aluminum housing provides a superior corrosion resistance. The Induction system operates well in cold temperatures with an instant ON/re-strike capability. The long life and superior lumen maintenance of Induction significantly reduces maintenance costs and provides a significant reduction in the total cost of ownership.

**APPLICATION -**

- Parking Lots
- Tennis Courts
- Intended use for Replacements of HID Area Lighting

- Dealerships
- Public Areas

**CONSTRUCTION -**

- Squared Welded Aluminum Housing
- Corrosion Resistant
- Profile Generator
- Standard Powder Coated Finish: Dark Bronze
- Optional: Slip fitter (Round Pole), 6" Square Arm and 8" Square Arm

- Separate Generator and Lamp Compartment is Engineered for Great Reliability and Easy Maintenance
- Square Mounting Arm, Optional Slip Fitter
- Flat Clear Tempered Glass Lens
- 4" Squared Mounting Arm (Standard)

**ELECTRICAL -**

- Universal Voltage (120V – 277V)
- High Power Factor (>.95)
- Ambient Temperature Rating: -20°C to 40°C
- Input Frequency: 50/60 Hz
- Operating Frequency: 250 kHz
- Generator Type: Class P Type 1 outdoor
- CSA: 208V-347V

- THD %: < 10%
- Pre-Wired Output Connector (Plug and Play)
- Constant Wattage Output With Less Than 3% Variance
- No Variation Over a Wide Range of Temperatures and Voltage Fluctuation
- Instant On
- No Noise Compare to HID Systems

**LAMP TYPE/WATTAGES -**

- Circular Induction Lamps Available: 150W, 200W, 250W
- Standard Kelvin Temperature is 5000K: Provides a Cooler Color Temperature
- CRI>80
- Vibration and Shock Resistant: No Filament

- Wide Range of Color Temperature Options 2700K – 6500K<sup>1</sup> Available
- Pre-Wired Input Connector
- Low Lumen Depreciation, >70% Lumen Maintenance at 60,000 Hours

**COMPLIANCE -**

- UL listed – UL 1598 (E363375)
- cUL listed – UL 1598 (E363375)
- CSA listed<sup>1</sup>: 150W, 200W, 250W

- IP54: Suitable for Wet Location
- Surge Immunity – IEC 61000-4-5: Class 4
- FCC Part 18-A

**DIMMING INDUCTION GENERATOR SPECIFICATIONS -**

- Dimming interface is electrically isolated for safety and reliability
- Dimmable Induction generator can work as a regular generator to drive the lamp at full range when the 0-10V interface is not connected.
- The output wattage is about 50% at 0-3VDC.
- The output wattage is dimmed from 100% to 50% at the 9-3VDC.
- Dimming wires: Violet (+), Gray (-)
- The output wattage is 100% at 9-10VDC.

- The output wattage is at the 100% range when the system is power ON. If the system is set on a dim level then it will dim within 30 seconds.
- Shorting the two dimming wires (Violet and Gray) sets the system to the lowest dim level of 50%, acting as a bi-level dimming system.

**OPTICS -**

- Symmetric Hydroformed Aluminum Reflector
- High Reflectivity Vacuum Coated Inner Surface Finish

- Clear Glass Lens with High Light Penetration
- Type V Distribution

**WARRANTY -**

- Five-year Limited Warranty

PROFILE INDUCTION GENERATOR

CIRCULAR INDUCTION  
150W – 250W

MOUNTING HEIGHT  
12' TO 40'

DIMMING WATTAGES  
CIRCULAR 150W-250W



Actual performance may differ as a result of end-user environment and application.  
Note: Specifications subject to change without notice.

NOTE:  
1 Consult with your sales representative for availability.  
2 Consult with your sales representative for lead time.  
3. Dimming Generator, No Sensor included

### ORDERING OPTIONS

Lead times will vary depending on options selected. Consult with your sales representative.

TYPE	SERIES	LAMP	WATTAGE	LENS	MOUNTING	ORDERING OPTIONS
SB = SHOEBOX	02 = 02 SERIES	C = CIRCULAR	150 = 150W 200 = 200W 250 = 250W	G = GLASS	BLANK = 4" SQUARE ARM 6 = 6" SQUARE ARM <sup>1</sup> 8 = 8" SQUARE ARM <sup>1</sup> I = SLIPFITTER (ROUND POLE) <sup>1</sup>	M = 0-10V Dimming <sup>3</sup> BLANK = 5000K 27 = 2700K 30 = 3000K 40 = 4000K 60 = 6000K 65 = 6500K J = CSA <sup>1</sup>

Example: SB-02-C200-G (Shoebox 02 series Circular 200W lamp with Glass lens and 4" Square Arm)

### ACCESSORIES

DESCRIPTION:	PART NUMBER:
STEP DOWN TRANSFORMER	
250W-400W	HH-ILS-SD3-460VA



### ELECTRICAL CHARACTERISTICS

MODEL NO.	RATED WATTAGE (W)	INPUT POWER (W)	INPUT CURRENT 120V - 277V (AMP)	LAMP RATED INITIAL LUMINANCE (LM)	EFFICACY (LM/W)	LUMEN MAINTENANCE	COLOR RENDERING INDEX	CCT (KELVIN)
SB02-C150-G/M SB02-C150-G-I/M	150	158	1.32 - 0.57	12750	80 - 85	70%-75%	> 80	5000
SB02-C200-G/M SB02-C200-G-I/M	200	210	1.75 - 0.76	17000	80 - 85			
SB02-C250-G/M SB02-C250-G-I/M	250	263	2.19 - 0.95	22500	85 - 90			

### Mechanical Data

#### SQUARE MOUNTING ARM

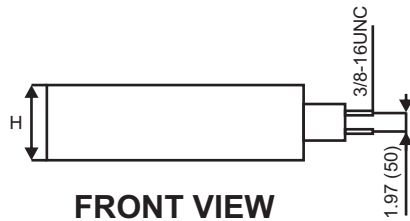

FRONT VIEW

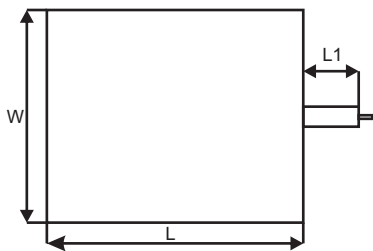

TOP VIEW

	L	W	H
150W	24.49 (622)	21.73 (522)	6.50 (165)
200W	26.85 (682)	23.70 (602)	8.07 (205)

#### SLIP FITTER (ROUND POLE) (OPTIONAL)

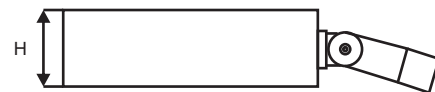

FRONT VIEW

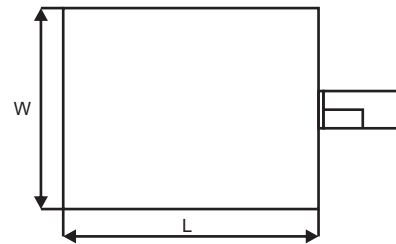

TOP VIEW

	L	W	H
150W	24.61 (625)	21.85 (555)	6.50 (165)
200W	26.97 (685)	23.82 (605)	8.07 (205)

#### SQUARE MOUNTING ARM

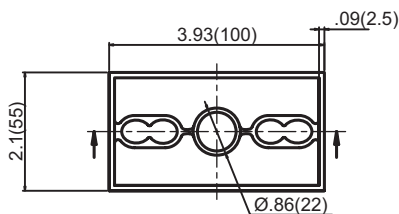

Length(L)
4"
6"
8"

#### SLIPFITTER (ROUND POLE)

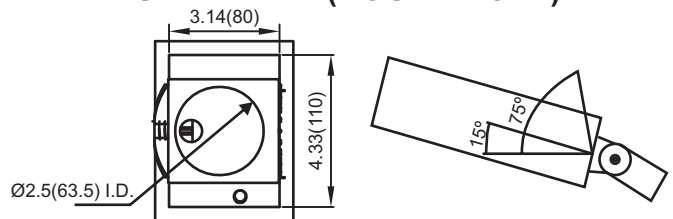

Recommended for 2"(50mm) pipe [2.375"(60mm) O.D.]

(Cord Length : 10")

All dimensions are shown in inches (millimeters) unless otherwise noted.

## SB02 Induction Shoebox Series

### Photometric Data

IES files available upon request.

#### POLAR GRAPH

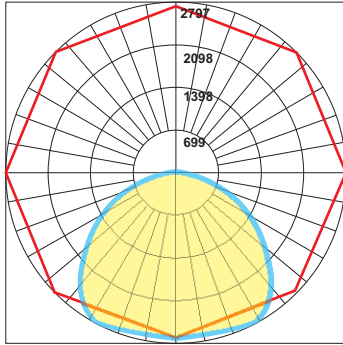

**SB02-C150-G/M**

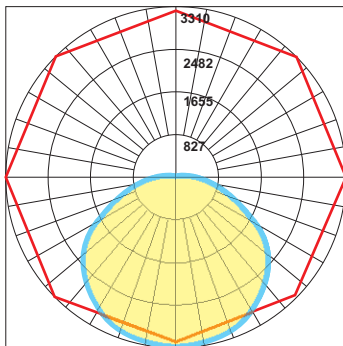

**SB02-C200-G/M**

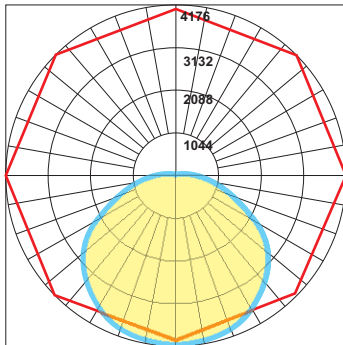

**SB02-C250-G/M**

#### ILLUMINANCE AT DISTANCE

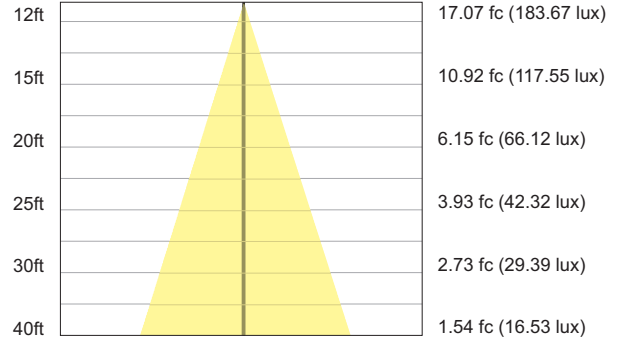

**SB02-C150-G/M**

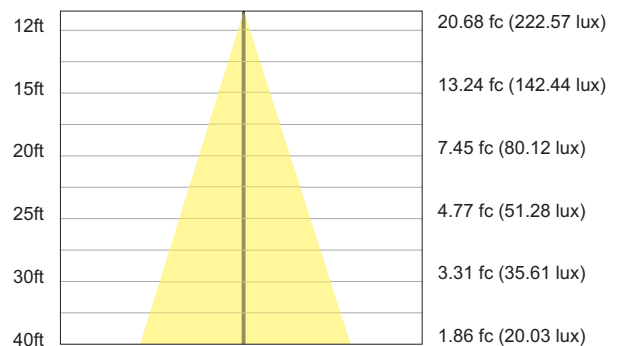

**SB02-C200-G/M**

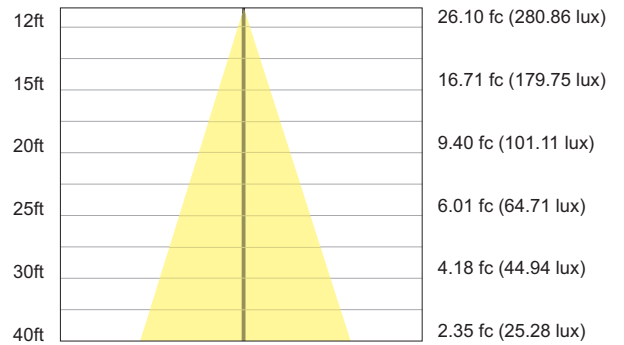

**SB02-C250-G/M**

Located At Horizontal Angle = 0, Vertical Angle = 0  
 # 1 - Vertical Plane Through Horizontal Angles (0 - 180) (Through Max. Cd.)  
 # 2 - Horizontal Cone Through Vertical Angle (0) (Through Max. Cd.)