

Basic Collection

SHOEBOXES

Discontinued
Contact Fulham for availability. Not for use in new designs.



SB01 Induction Shoebox Series

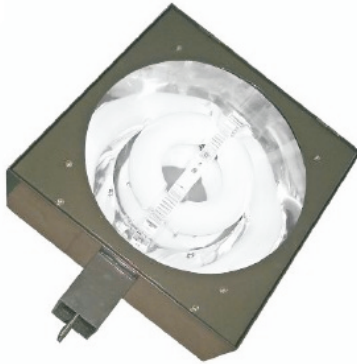

The **SB01 Induction Shoebox Series** can be used in a variety of applications including parking lots, tennis court, public areas, and dealerships. Optimized for heights of 8ft to 15ft. Square-welded aluminum housing with superior corrosion resistance. The Induction system operates well in cold temperatures with an instant ON/re-strike capability. The long life and superior lumen maintenance of Induction significantly reduces maintenance costs and provides a significant reduction in the total cost of ownership.

APPLICATION -

- Parking Lots
- Tennis Courts
- Intended use for Replacements of HID High Bay

- Dealerships
- Public Areas

CONSTRUCTION -

- Squared Welded Aluminum Housing
- Corrosion Resistant
- Standard Powder Coated Finish: Dark Bronze
- Optional: Slip fitter (Round Pole), 6" Square Arm and 8" Square Arm

- Flat Clear Tempered Glass Lens
- Integrated Structure for Lamp and Ballast
- 4" Square Mounting Arm (Standard)
- Profile Generator

ELECTRICAL -

- Universal Voltage (120V – 277V)
- High Power Factor (>.95)
- Ambient Temperature Rating: -20°C to 40°C
- Input Frequency: 50/60 Hz
- Operating Frequency: 250 kHz
- Generator Type: Class P Type 1 outdoor
- No Noise Compare to HID Systems

- THD %: < 10%
- Pre-Wired Output Connector (Plug and Play)
- Constant Wattage Output With Less Than 3% Variance
- No Variation Over a Wide Range of Temperatures and Voltage Fluctuation
- Instant On

LAMP TYPE/WATTAGES -

- Circular Induction Lamps Available: 40W¹, 55W¹, 70W¹, 80W¹, 100W
- Standard Kelvin Temperature is 5000K: Provides a Cooler Color Temperature
- CRI>80
- Vibration and Shock Resistant: No Filament

- Wide Range of Color Temperature Options 2700K – 6500K¹ Available
- Pre-Wired Input Connector
- Low Lumen Depreciation, >70% Lumen Maintenance at 60,000 Hours

COMPLIANCE -

- UL listed – UL 1598 (E363375)
- cUL listed – UL 1598 (E363375)
- FCC Part 18-A

- IP54: Suitable for Wet Location
- Surge Immunity – IEC 61000-4-5: Class 4

DIMMING INDUCTION GENERATOR SPECIFICATIONS -

- Dimming interface is electrically isolated for safety and reliability
- Dimmable Induction generator can work as a regular generator to drive the lamp at full range when the 0-10V interface is not connected.
- The output wattage is about 50% at 0-3VDC.
- The output wattage is dimmed from 100% to 50% at the 9-3VDC.
- Dimming wires: Violet (+), Gray (-)
- The output wattage is 100% at 9-10VDC.

- The output wattage is at the 100% range when the system is power ON. If the system is set on a dim level then it will dim within 30 seconds.
- Shorting the two dimming wires (Violet and Gray) sets the system to the lowest dim level of 50%, acting as a bi-level dimming system.

OPTICS -

- Symmetric Hydroformed Aluminum Reflector
- High Reflectivity Vacuum Coated Inner Surface Finish

- Clear Glass Lens with High Light Penetration
- Type V Distribution

WARRANTY -

- Five-year Limited Warranty

NOTE:
1 Consult with your sales representative for availability.
2 Consult with your sales representative for lead time.
3. Dimming Generator, No Sensor included

Actual performance may differ as a result of end-user environment and application.
Note: Specifications subject to change without notice.

ORDERING OPTIONS

Lead times will vary depending on options selected. Consult with your sales representative.

TYPE	SERIES	LAMP	WATTAGE	LENS	MOUNTING	ORDERING OPTIONS
SB = SHOEBOX	01 = 01 SERIES	C = CIRCULAR	040 = 40W 055 = 55W 070 = 70W 080 = 80W 100 = 100W	G= GLASS	BLANK = 4" SQUARE ARM 6 = 6" SQUARE ARM ¹ 8 = 8" SQUARE ARM ¹ I = SLIPFITTER (ROUND POLE) ¹	M = 0-10V Dimming ³ BLANK = 5000K 27 = 2700K 30 = 3000K 40 = 4000K 60 = 6000K 65 = 6500K

Example: SB-01-C100-G (Shoebbox 01 series Circular 100W lamp with Glass lens and 4" Square Arm)

ACCESSORIES

DESCRIPTION:	PART NUMBER:
STEP DOWN TRANSFORMER	
35W-100W	HH-ILS-SD1-125VA



ELECTRICAL CHARACTERISTICS

MODEL NO.	RATED WATTAGE (W)	INPUT POWER (W)	INPUT CURRENT 120V - 277V (AMP)	LAMP RATED INITIAL LUMINANCE (LM)	EFFICACY (LM/W)	LUMEN MAINTENANCE	COLOR RENDERING INDEX	CCT (KELVIN)
SB01-C040-G/M SB01-C040-G-I/M	40	42	0.35 - 0.15	3000	70 - 75	70%-75%	> 80	5000
SB01-C055-G/M SB01-C055-G-I/M	55	58	0.48 - 0.21	4380	75 - 80			
SB01-C070-G/M SB01-C070-G-I/M	70	74	0.62 - 0.27	5250	70 - 75			
SB01-C080-G/M SB01-C080-G-I/M	80	84	0.70 - 0.30	6000	70 - 75			
SB01-C100-G/M SB01-C100-G-I/M	100	105	0.88 - 0.38	8000	75 - 80			

Mechanical Data

SQUARE MOUNTING ARM

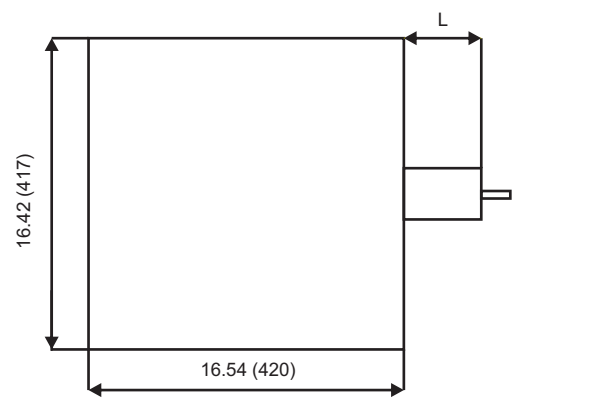

TOP VIEW

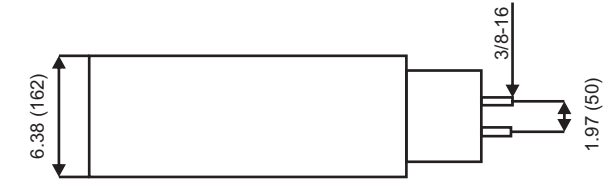

FRONT VIEW

SLIPFITTER (ROUND POLE) (OPTIONAL)



TOP VIEW

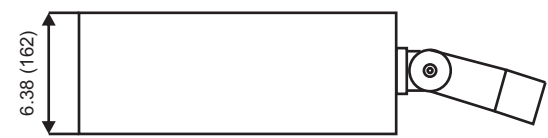

FRONT VIEW

SQUARE MOUNTING ARM

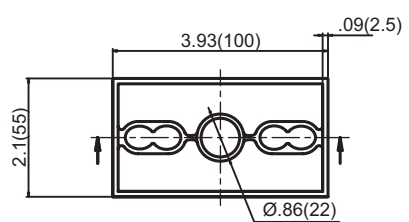

Length(L)
4"
6"
8"

SLIPFITTER (ROUND POLE)

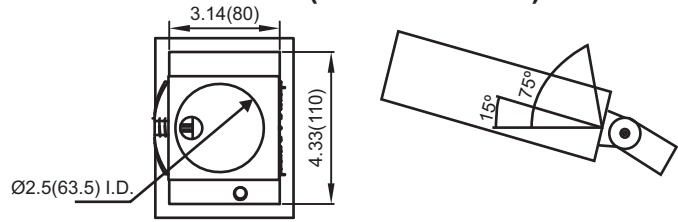

Recommended for 2"(50mm) pipe [2.375"(60mm) O.D.]

All dimensions are shown in inches (millimeters) unless otherwise noted.

SB01 Induction Shoebox Series

Photometric Data

IES files available upon request.

POLAR GRAPH

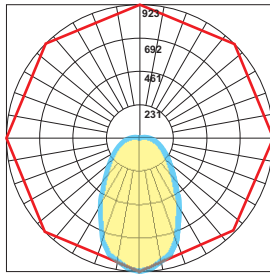

SB01-C040-G/M

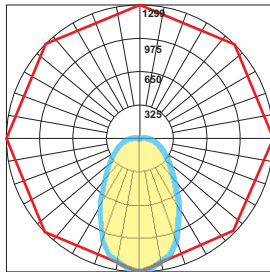

SB01-C055-G/M

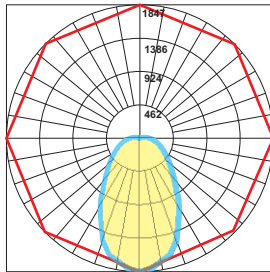

SB01-C070-G/M

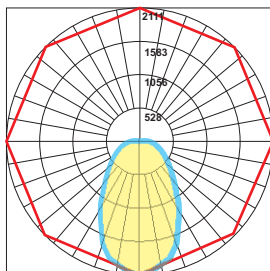

SB01-C080-G/M

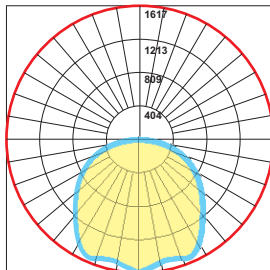

SB01-C100-G/M

ILLUMINANCE AT DISTANCE

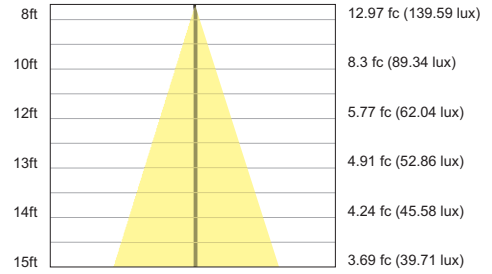

SB01-C040-G/M

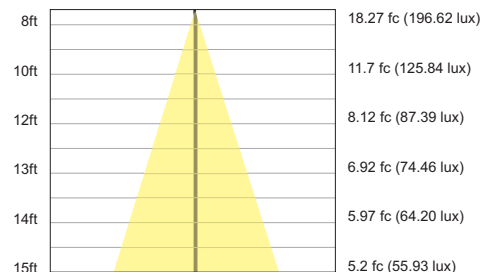

SB01-C055-G/M

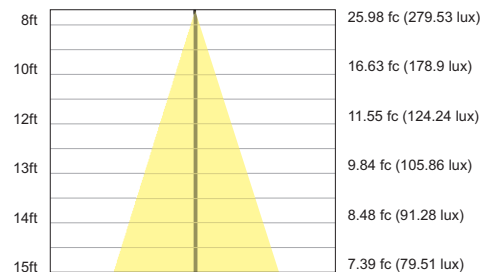

SB01-C070-G/M

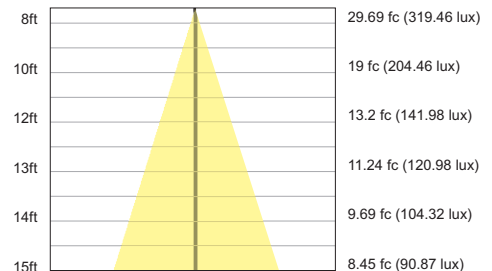

SB01-C080-G/M

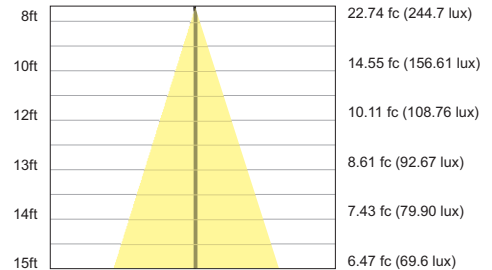

SB01-C100-G/M

Located At Horizontal Angle = 0, Vertical Angle = 0

1 - Vertical Plane Through Horizontal Angles (0 - 180) (Through Max. Cd.)

2 - Horizontal Cone Through Vertical Angle (0) (Through Max. Cd.)