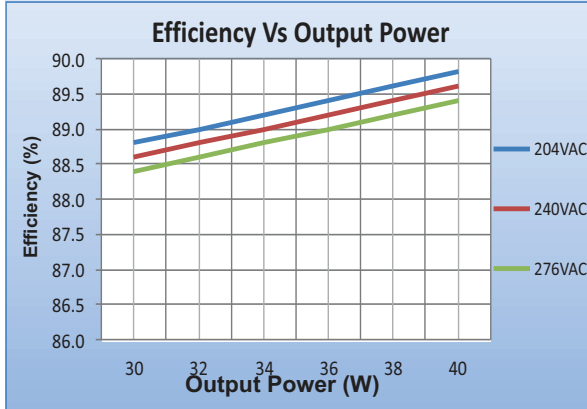
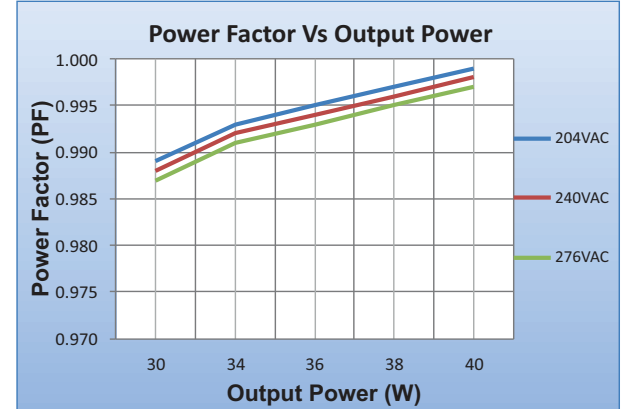
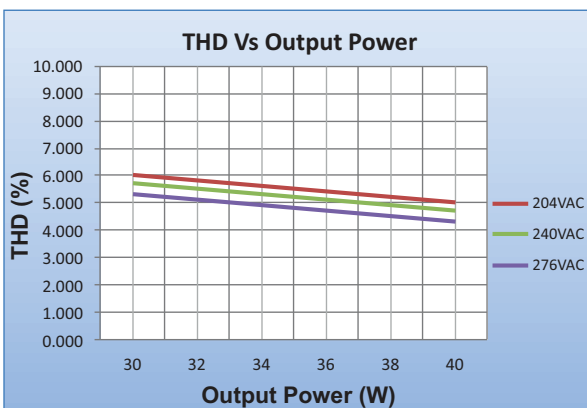
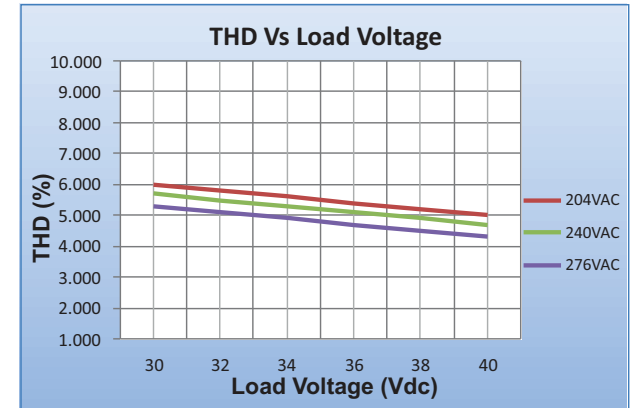
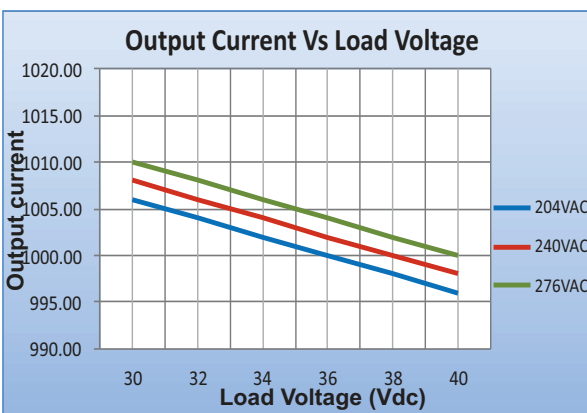

- Constant Current LED Driver
- Output Wattage: 40W
- Input Voltage: 240Vac  $\pm 15\%$ , 50Hz
- Output Current: 1000mA  $\pm 8\%$
- Wired; CRCA Enclosure
- Output voltage range of 30-40Vdc
- Dry and Damp Locations
- SELV Equivalent
- Under Voltage Protection
- Over Voltage Protection
- 440Vac Protection

#### General Specifications

Rated Input Voltage	240Vac $\pm 15\%$ , 50Hz
Operating Input Voltage Range	110Vac~320Vac, 50Hz
Input Current	0.4 A Max.
Input Power	49W Max.
Power Factor	>0.95
THD	<10% across load range specified
Efficiency	>86% across load range specified
Driver Type	Constant Current
Output Current	1000mA $\pm 8\%$
Output Voltage Range	30-40Vdc
Output Power	40W
Number of Output Channels	1 Channel
Dimming Controller Type/Dimming Range	NA
RFI/EMI	NA
Output Type	Class II
Ambient Operating Temperature Range	-10°C to 50°C
Max. Case Temperature	80°C
Sound Rating	NA
Input Surge Protection	Line-Neutral 4kV DM
Protections	Input Over Current : NON-Resettable
	Input Over Voltage : CUTOFF @ Vin > 325Vac; AUTORECOVERY @ Vin = 300-315Vac : Immunity - 320Vac for 48 hours & 440Vac for 8 hours
	Input Under Voltage : CUTOFF @ Vin < 100Vac; AUTORECOVERY @ Vin = 100-110Vac
	Output Short Circuit : Auto recovery
	Output Open Circuit : Auto recovery
	Output to ground short : YES
	Output Overload : YES
	Over Temperature : NA
Service Life	50,000 hours @ Tc Max
Approvals / Class	SELV Equivalent, Dry and Damp Locations
Warranty	3 Years
Weight	0.500Kg

Note : The usage of a compatible\* SPD is mandatory for outdoor application.

**Figure 1**

**Figure 2**

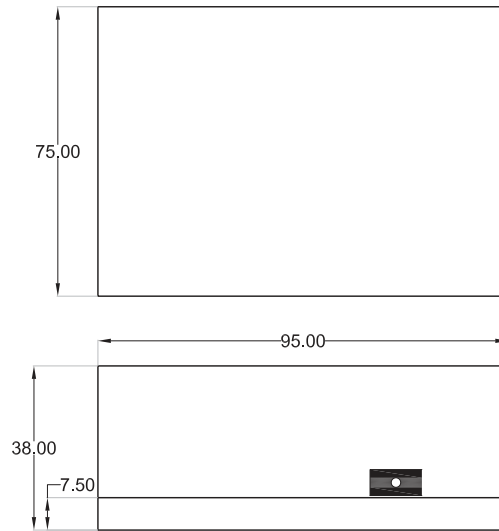
**Figure 3**

**Figure 4**

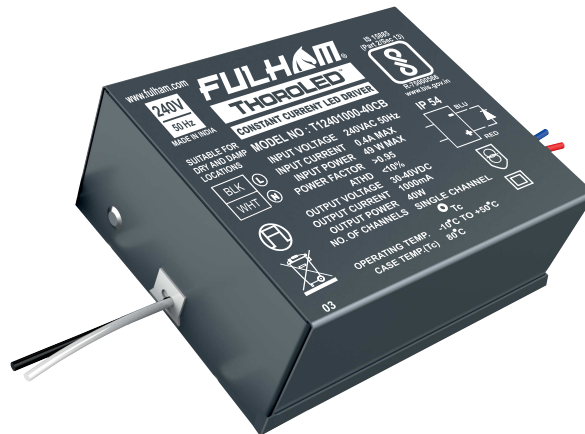
**Figure 5**

### Mechanical Data



### Product Image



Note : All Dimensions are in mm.

Tolerance=±0.5mm

### Wiring Diagrams

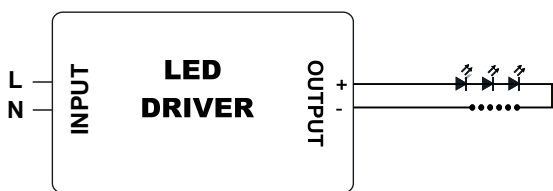

INPUT SIDE	LENGTH
BLACK	250 mm
WHITE	250 mm

OUTPUT SIDE	LENGTH
RED	250 mm
BLUE	250 mm
Output wire with Terminal: N. A.	

### Installation Instructions:

Connect Wires as per details given on the Driver Screen. Keep proper ventilation around the LED Driver and do not stack any object on it. Also a 10-15 cm clearance must be kept when the adjacent device is a heat source. Do not exceed the declared Hot spot temperature(Tc max) under any circumstances.

Fulham extends a limited warranty only to the original purchaser or to the first user for a period of **3 years @ Tc 80°C** from the date of manufacture when properly installed and operated under normal conditions of use. For complete terms and conditions, please reference the Fulham Product Catalog ([www.fulham.com](http://www.fulham.com)). Due to a program of continuous improvement, Fulham reserves the right to make modifications or variations in design or construction to the equipment described. © Fulham Company Limited, All Rights Reserved.