

- Constant Current LED Driver
- Output Wattage: 38W
- Rated Input Voltage: 160-280Vac, 50Hz
- Output Current: 950mA \pm 7%
- CRCA enclosure with Wires
- Output voltage range of 30-39Vdc
- Suitable for Dry and Damp Locations
- 440Vac application @ 48Hrs
- Surge Immunity 4KV
- Class II

General Specifications

Rated Input Voltage	160-280Vac, 50Hz
Operating Input Voltage Range	110-300Vac, 50Hz
Input Current	0.2A Max (@240Vac)
Input Power	45W Max.
Power Factor	>0.95
ATHD	<10%
Efficiency	>86% ^①
Driver Type	Constant Current
Output Current	950mA \pm 7%
Output Voltage Range	30~39Vdc
No Load Output Voltage	55Vdc Max
Output Power	38W (Typical @240Vac)
Number of Output Channels	1 Channel
Dimming Controller Type/Dimming Range	NA
Output Type	Suitable for Class II Fixtures
Ambient Operating Temperature Range	-10°C to 55°C
Max. Case Temperature	75°C Max.
Input Surge Protection	Line-Neutral 4kV As per EN 61000-4-5
Protections	Input Over Current : NON-Resettable
	Input Over Voltage : Shutdown @ >300Vac, Auto recovery 300Vac for 48 hours & 440Vac for 48 hours
	Input Under Voltage : Shutdown < 100Vac, Auto recovery
	Output Short Circuit : Auto Recovery (HICCUP MODE)
	Output Open Circuit : Auto Recovery (HICCUP MODE)
	Output Overload : YES
	Over Temperature : Thermal Foldback
Service Life	50,000 hours @ Tc Max
Approvals / Class	SELV Equivalent, Dry and Damp Locations
Warranty	3 Years
Weight	0.280 Kg

Note : The usage of a compatible SPD is mandatory for outdoor application.

Recommended Fulham SPD - SPD1230S5A5K54

① - Output voltage range 35-39Vdc

Figure 1

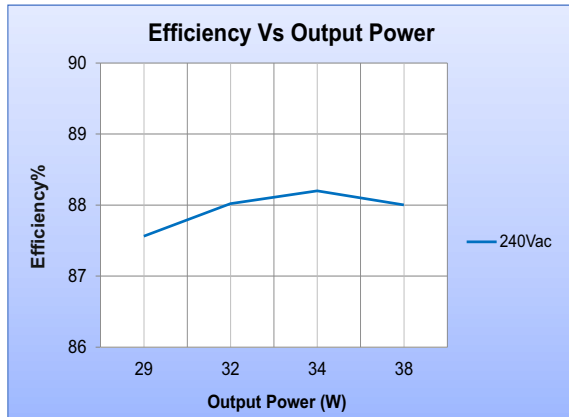

Figure 2

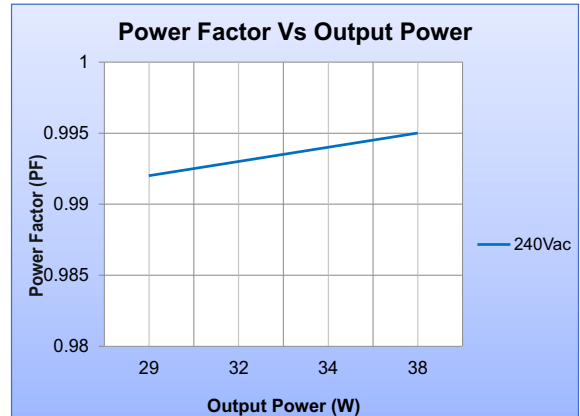

Figure 3

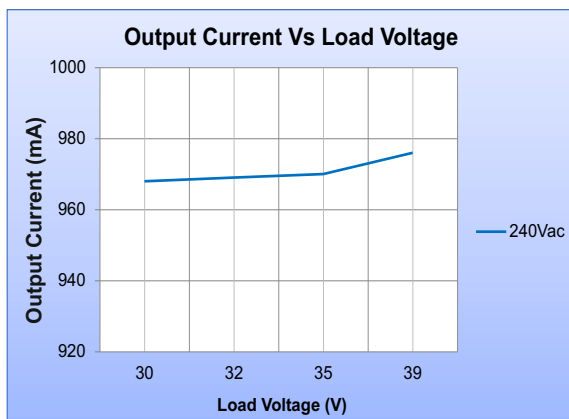

Figure 4

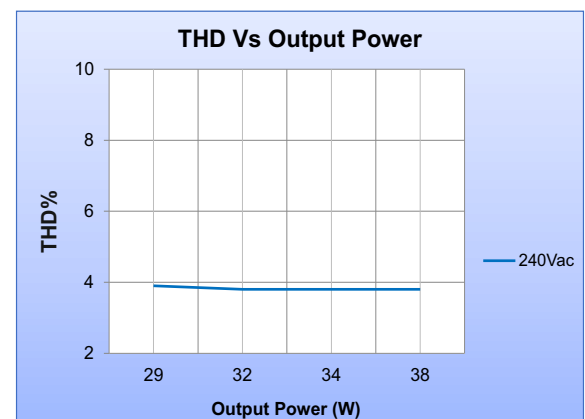
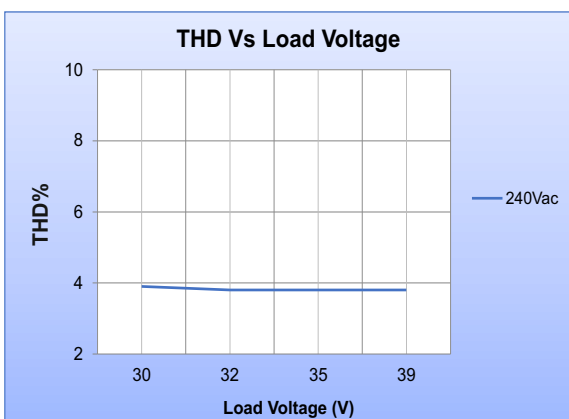
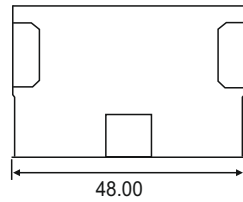

Figure 5



Mechanical Data :



R.H.S.V

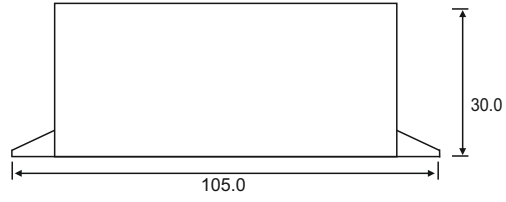

B.V.

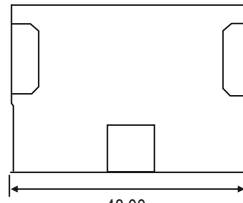

L.H.S.V

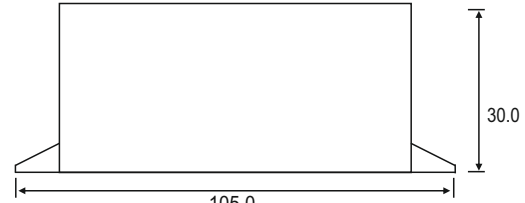

F.V.

Product Image :

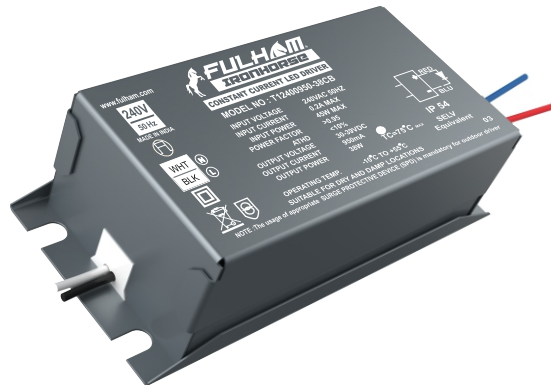

Note : All Dimensions are in mm. Tolerance=±0.5mm

Wiring Diagrams :



INPUT SIDE	LENGTH	OUTPUT SIDE	LENGTH
BLACK (L)	200 ± 5mm	RED (+)	200 ± 5mm
WHITE (N)		BLUE (-)	

Packaging :

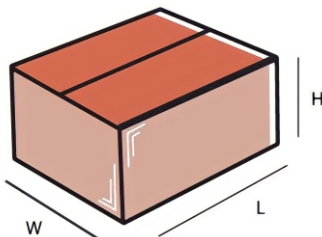

Master carton

OUTER DIMENSION		
L	W	H
270mm	210mm	122mm
Net Weight	Gross Weight	QUANTITY
8.4 kg	8.6 kg	30 pc.

Installation Instructions:

Connect Wires as per details given on the Driver Screen. Keep proper ventilation around the LED Driver and do not stack any object on it. Also a 10-15 cm clearance must be kept when the adjacent device is a heat source. Do not exceed the declared Hot spot temperature (Tc max) under any circumstances.

Fulham extends a limited warranty only to the original purchaser or to the first user for a period of **3 years @ Tc Max** from the date of manufacture when properly installed and operated under normal conditions of use. For complete terms and conditions, please reference the Fulham Product Catalog (www.fulham.com). Due to a program of continuous improvement, Fulham reserves the right to make modifications or variations in design or construction to the equipment described. © Fulham Company Limited, All Rights Reserved.