

- Constant Current LED Driver
- Multiple Current Selection by DIP Switch
- O/P Current - 350, 400, 450 OR 500mA
- Output Current Tolerance $\pm 10\%$
- Output Wattage: 25W
- Output voltage range of 30-50Vdc
- Suitable for Class II Fixtures
- Surge Immunity 4KV
- I/P Over Voltage Protection
- Compact Linear Form Factor W30xH23

General Specifications

Rated Input Voltage	230Vac $\pm 20\%$, 50 Hz
Operating Input Voltage Range	100-300Vac, 50 Hz
Input Current	0.14 A Max @ 240Vac
Input Power	31.5W Max [Ⓢ]
Power Factor	>0.95 [Ⓢ]
THD	$<15\%$ [Ⓢ]
Efficiency	$\geq 85\%$ [Ⓢ]
Driver Type	Constant Current
Output Current	500mA $\pm 10\%$, 450mA $\pm 10\%$, 400mA $\pm 10\%$, 350mA $\pm 10\%$ *Refer DIP switch Table for O/P current selection
Output Voltage Range	30-50Vdc
Output Power	25W Max
Number of Output Channels	1 Channel
Output Type	Suitable for Class II Fixtures
Dimming Controller Type	NA
Dimming Range	NA
Ambient Operating Temperature Range	-10°C to 50°C
Max. Case Temperature	75°C
Input Surge Protection	L-N - 4KV
Protections	Input Over Current : Non Resettable (Fuse) Input Over Voltage : Cutoff @ $V_{in} > 325V_{ac}$; Auto Recovery @ $V_{in} = 300-315V_{ac}$: Immunity - 320Vac for 48 hours & 440Vac for 8 hours Input Under Voltage : NA Output Short Circuit : Auto Recovery (HICCUP Mode) Output Open Circuit : Auto Recovery (HICCUP Mode) Output to Ground short : YES Output Overload : YES Over Temperature : NA
Service Life	50,000 Hours @ Tc Max
Approvals / Class	SELV Equivalent ; Dry Locations
Warranty	03 Years
Weight	0.155 Kg

Note : Suitable for Indoor application only

- Ⓢ 240VAC at Full load.
- Ⓢ Typical @ 240Vac

DIP Switch Chart :

I _{rated} (mA)	DIP Switch		P _{rated} (W)
	PIN 1	PIN 2	
500mA	ON	ON	25.0
450mA	ON	OFF	22.5
400mA	OFF	ON	20.0
350mA	OFF	OFF	17.5

Fulham extends a limited warranty only to the original purchaser or to the first user for a period of **03 years @ Tc 75°C** from the date of manufacture when properly installed and operated under normal conditions of use. For complete terms and conditions, please reference the Fulham Product Catalog (www.fulham.com). Due to a program of continuous improvement, Fulham reserves the right to make modifications or variations in design or construction to the equipment described.

© Fulham Company Limited, All Rights Reserved.

Figure 1

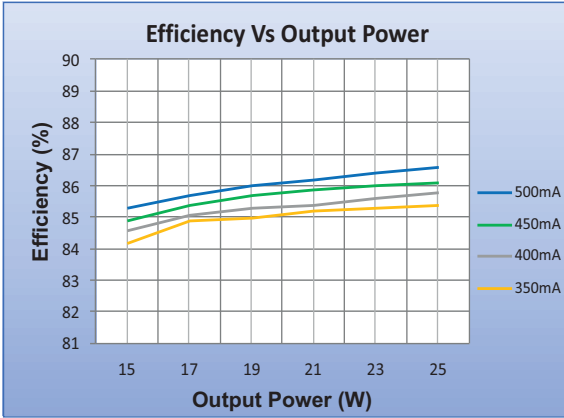

Figure 2

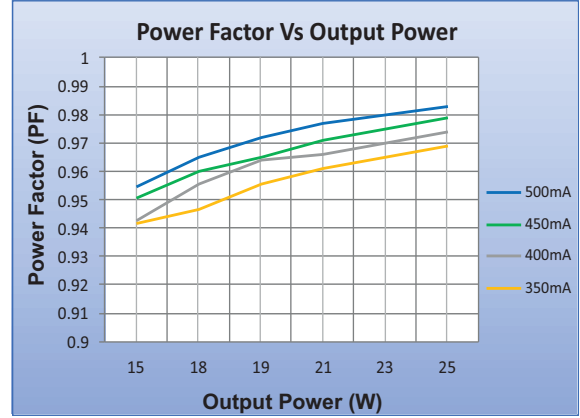

Figure 3

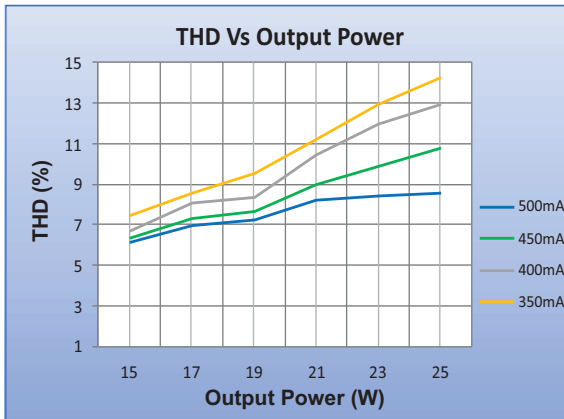

Figure 4

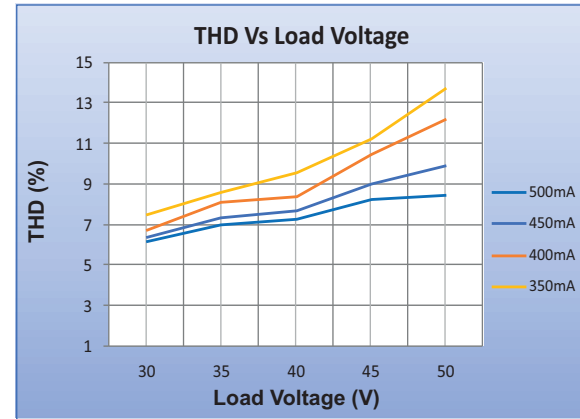
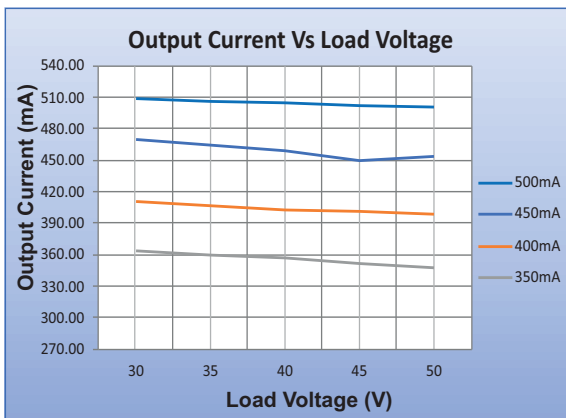
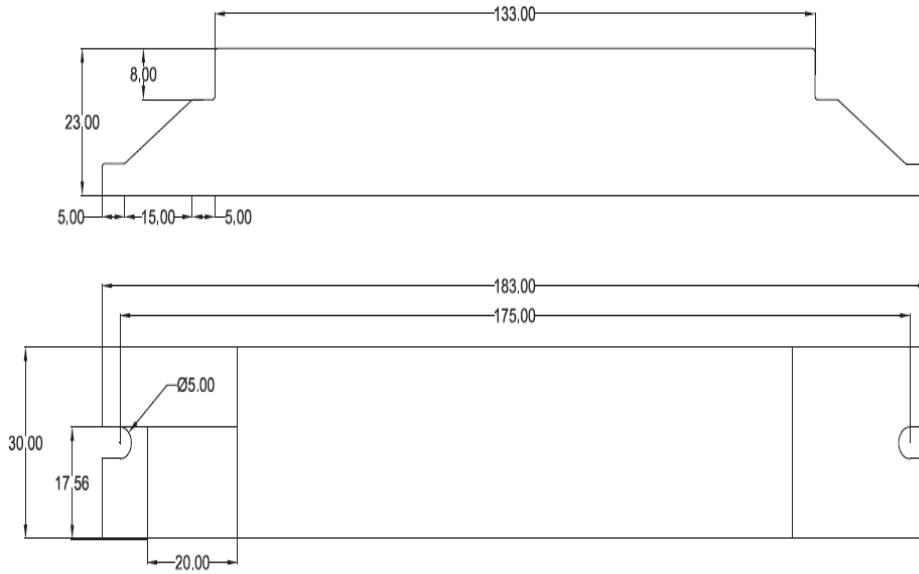

Figure 5



Mechanical Data



Product Image

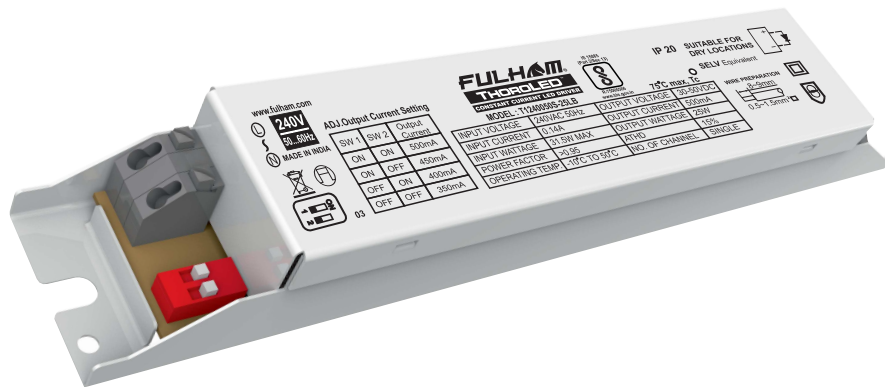

Note : All Dimensions are in mm.

Tolerance=±0.5mm

Wiring Diagrams

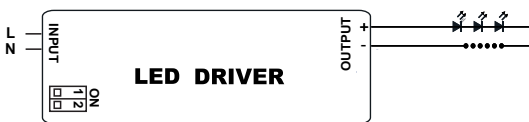

INPUT 2 PIN CONNECTOR	GREY	LINE
	GREY	NEUTRAL

OUTPUT 2 PIN CONNECTOR	ORANGE	POSITIVE
	GREY	NEGATIVE

Installation Instructions:

Connect Wires as per details given on the Driver Screen. Keep proper ventilation around the LED Driver and do not stack any object on it. Also a 10-15 cm clearance must be kept when the adjacent device is a heat source. Do not exceed the declared Hot spot temperature(Tc max) under any circumstances.

Fulham extends a limited warranty only to the original purchaser or to the first user for a period of **03 years @ Tc 75°C** from the date of manufacture when properly installed and operated under normal conditions of use. For complete terms and conditions, please reference the Fulham Product Catalog (www.fulham.com). Due to a program of continuous improvement, Fulham reserves the right to make modifications or variations in design or construction to the equipment described. © Fulham Company Limited, All Rights Reserved.