

- Constant Current LED Driver
- Multiple current selection through DIP switch.
- O/P Current - 250, 350, 450 OR 500mA
- Output Wattage - 22W
- Inbuilt Surge protection 4KV
- Output voltage range of 21~43Vdc
- Suitable For Dry Locations
- Application
- Shop, Retail & Hospitality

General Specifications

Rated Input Voltage	240Vac \pm 20%,50Hz
Operating Input Voltage Range	120-310Vac,50Hz
Input Current	0.11A Max @ 240Vac
Input Power	27W Max
Power Factor	>0.95 *
THD	<10% *
Efficiency	\geq 85% *
Driver Type	Constant Current
Output Current	500mA \pm 10%, 450mA \pm 10%, 350mA \pm 10%, 250mA \pm 10%* **Refer DIP switch Table for O/P current selection
Output Voltage Range	21~43Vdc
No Load Output Voltage	55Vdc Max
Output Power	22W Typical
Number of Output Channels	1 Channel
Output Type	Suitable for Class II Fixtures
Dimming Controller Type	NA
Dimming Range	NA
Ambient Operating Temperature Range	-20°C to 50°C
Max. Case Temperature	65°C
Input Surge Protection	L-N - 4KV as per EN 61000-4-5
Protections	Input Over Current : Non Resettable (Fuse) Input Over Voltage : Cutoff @ Vin 320 \pm 10Vac; Auto Recovery : Immunity - 320Vac for 48 hours & 440Vac for 48 hours Input Under Voltage : Shutdown <95Vac, Auto recovery Output Short Circuit : Auto Recovery (HICCUP Mode) Output Open Circuit : Auto Recovery (HICCUP Mode) Output to Ground short : YES Output Overload : YES Over Temperature : YES
Service Life	30,000 Hours @ Tc Max
Approvals / Class	SELV Equivalent ; Dry Locations
Warranty	03 Years
Weight	0.130 Kg

DIP Switch Chart :

I _{rated} (mA)	DIP Switch		P _{rated} (W)
	PIN 1	PIN 2	
500	ON	ON	21.50
450	ON	OFF	19.35
350	OFF	ON	15.05
250	OFF	OFF	10.75

Note : Suitable for Indoor application only
*240VAC Full Load

Fulham extends a limited warranty only to the original purchaser or to the first user for a period of 03 years @ Max Tc from the date of manufacture when properly installed and operated under normal conditions of use. For complete terms and conditions, please reference the Fulham Product Catalog (www.fulham.com). Due to a program of continuous improvement, Fulham reserves the right to make modifications or variations in design or construction to the equipment described.

© Fulham Company Limited, All Rights Reserved.

Figure 1

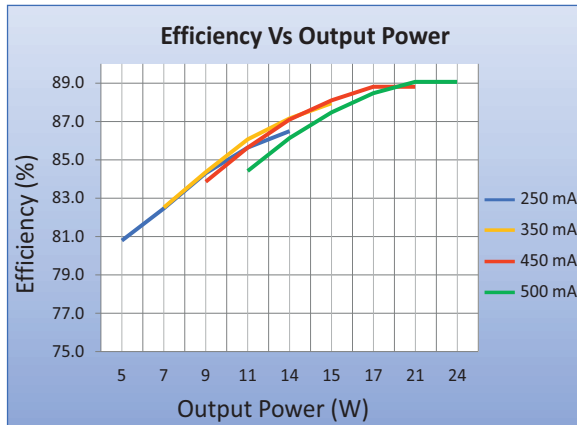

Figure 2

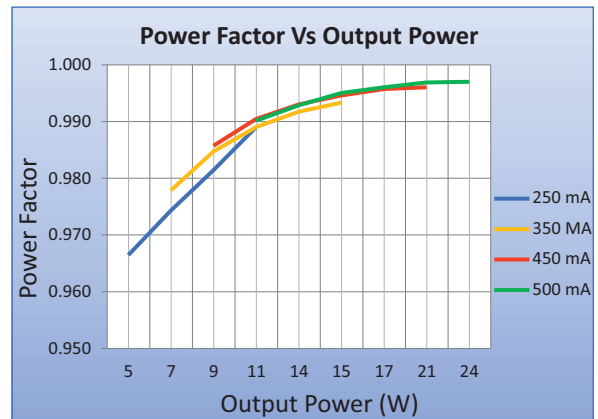

Figure 3

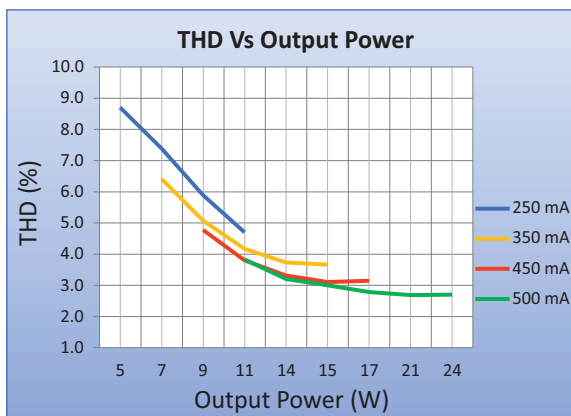

Figure 4

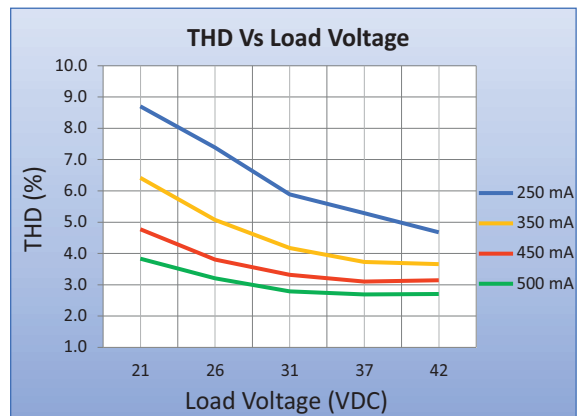
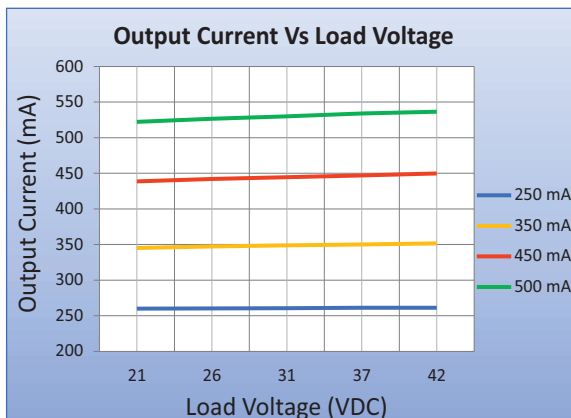
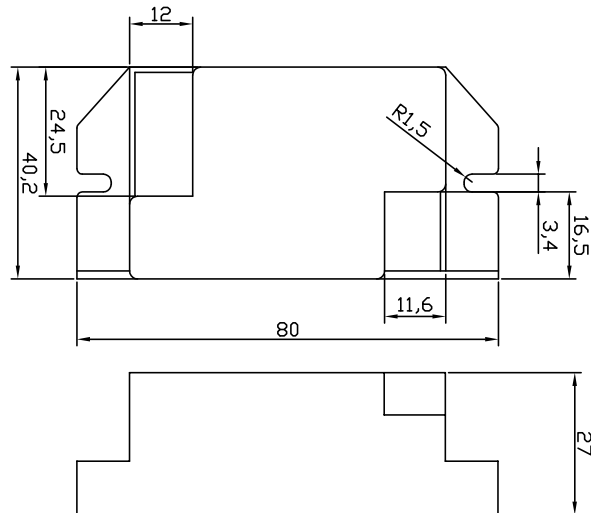

Figure 5



Mechanical Data



Product Image

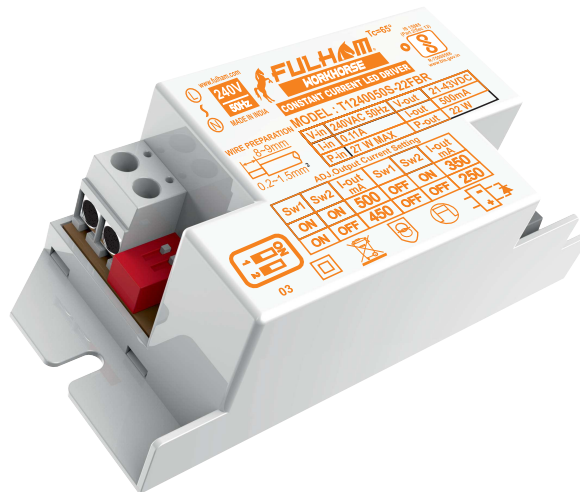

Note : All Dimensions are in mm.

Tolerance=±0.5mm

Wiring Diagrams



INPUT 2 PIN CONNECTOR	WHITE	LINE
	WHITE	NEUTRAL

OUTPUT 2 PIN CONNECTOR	GREY	NEGATIVE
	GREY	POSITIVE

Packaging

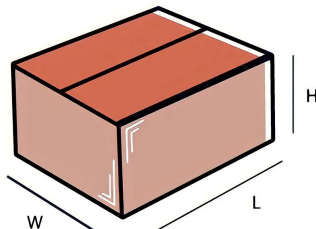

Master carton

OUTER DIMENSION		
L	W	H
(230mm)	(160mm)	(140mm)
Net Weight	Gross Weight	QUANTITY
(5.5 kg)	(6 kg)	60 pc.

Installation Instructions:

Connect Wires as per details given on the Driver Screen. Keep proper ventilation around the LED Driver and do not stack any object on it. Also a 10-15 cm clearance must be kept when the adjacent device is a heat source. Do not exceed the declared Hot spot temperature(Tc max) under any circumstances.

Fulham extends a limited warranty only to the original purchaser or to the first user for a period of **03 years @ Max Tc** from the date of manufacture when properly installed and operated under normal conditions of use. For complete terms and conditions, please reference the Fulham Product Catalog (www.fulham.com). Due to a program of continuous improvement, Fulham reserves the right to make modifications or variations in design or construction to the equipment described.
© Fulham Company Limited, All Rights Reserved.