

- Constant Current LED Driver
- Output Wattage: 13W
- Input Voltage: 240Vac,50Hz
- Output Current: 300mA \pm 10%
- PC cabinet with Wires
- Output voltage range of 26~42Vdc
- Suitable for Dry,Damp and Wet Locations
- Surge Immunity 4kV

General Specifications

Rated Input Voltage	240Vac,50Hz
Operating Input Voltage Range	90-300Vac,50Hz
Input Current	0.07A
Input Power	15W
Power Factor	>0.95
THD	<10%
Efficiency	>85%
Driver Type	Class II
Output Current	300mA \pm 10%
Output Voltage Range	26-42Vdc
No Load Output Voltage	52Vdc
Output Power	13W
Number of Output Channels	1Channel
Output Type	Constant Current
Ambient Operating Temperature Range	-20°C to 50°C
Max.Case Temperature	70°C Max.
Input Surge Protection	Line-Neutral 4kV as per EN 61000-4-5
Protections	Input Over Current : NON-Resettable
	Input Over Voltage : Application @ 320Vac 48Hrs & @ 360Vac 2Hrs
	Input Under Voltage : NA
	Output Short Circuit : Auto recovery (HICCUP MODE)
	Output to Ground short : Yes
	Output Overload : Yes
	Over Temperature : NA
ServiceLife	50,000 hours @ 70°C
Approvals/Class	Class II, Dry, Damp and Wet Locations, IP 67
Warranty	3 Years
Weight	0.150 Kg

Note : The usage of a compatible SPD is mandatory for outdoor application. Recommended Fulham SPD - SPD1230S5A5K54

Figure 1

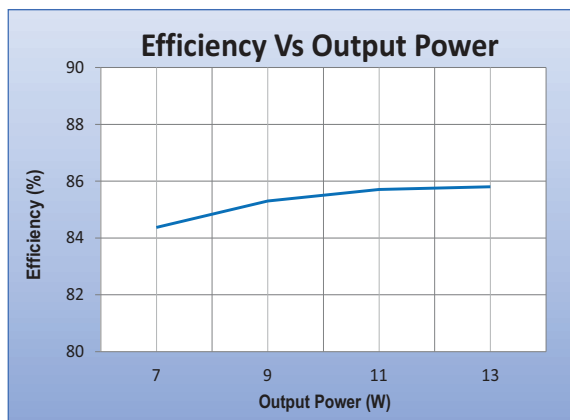

Figure 2

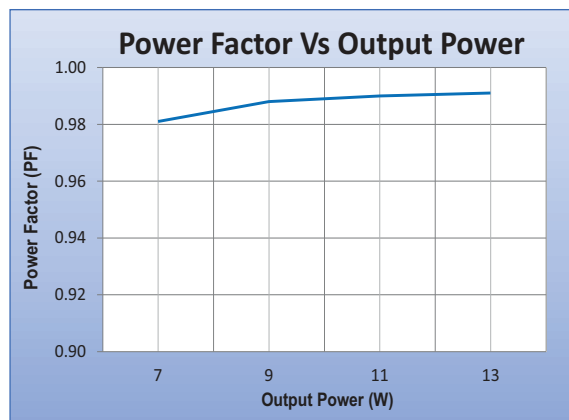

Figure 3

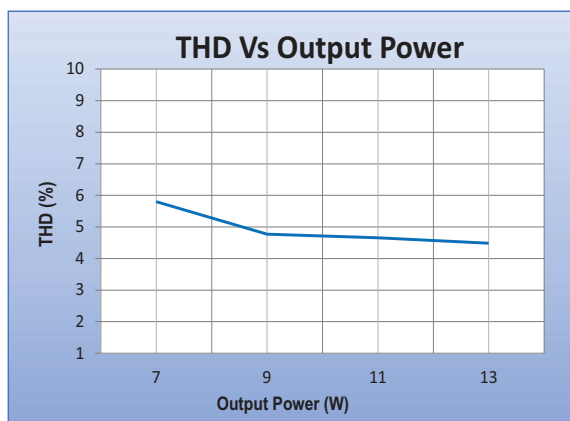

Figure 4

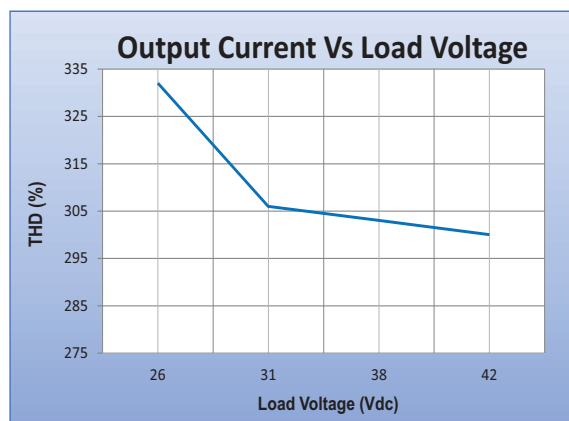
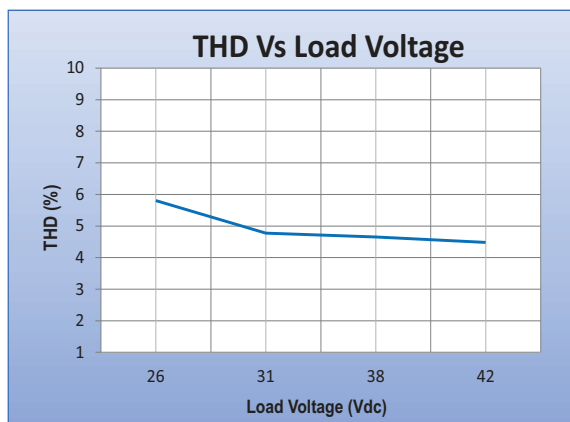
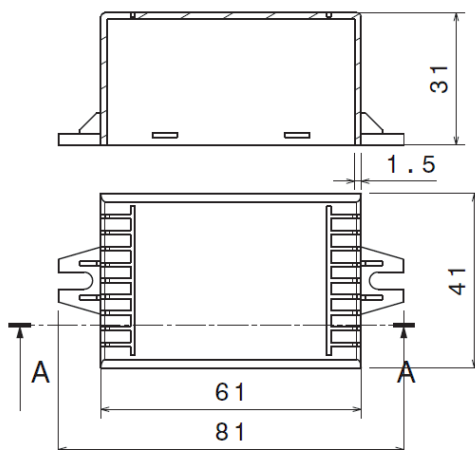

Figure 5



Mechanical Data



Product Image

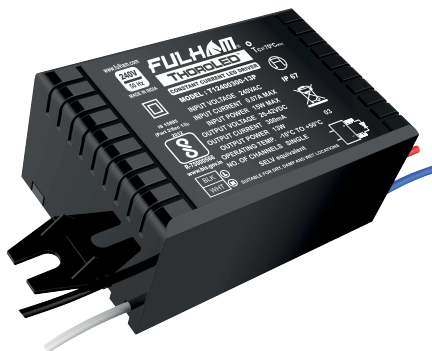

Note :All Dimensions are in mm .Tolerance=±0.5mm

Wiring Diagrams

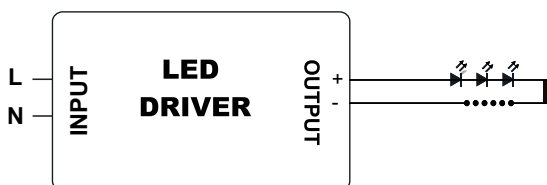

INPUT SIDE	LENGTH
BLACK	300 MM
WHITE	300 MM

OUTPUT SIDE	LENGTH
BLUE	300 MM
RED	300 MM
Output wire with Terminal: N.A	

Packaging

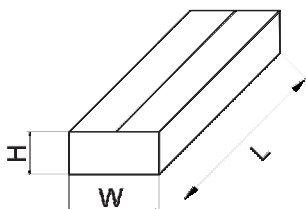

Master carton

OUTER DIMENSION		
L	W	H
10.03"(255mm)	6.5"(165mm)	3.75"(95mm)
Net Weight	Gross Weight	QUANTITY
6.95 lbs. (3.15 kg)	6.95 lbs. (3.15 kg)	20 pc.

Installation Instructions:

Connect Wires as per details given on the Driver Screen. Keep proper ventilation around the LED Driver and do not stack any object on it. Also a 10-15 cm clearance must be kept when the adjacent device is a heat source. Do not exceed the declared Hot spot temperature (Tc max) under any circumstances.