

- Constant Current LED Driver
- Output Wattage: 04W
- Input Voltage: 240 \pm 10%VAC, 50Hz
- Output Current: 250mA \pm 7%
- Plastic (ABS) Enclosure
- Output voltage range of 09-18VDC
- Suitable for Dry Locations
- SELV Equivalent

General Specifications

Rated Input Voltage	240VAC \pm 10%, 50 Hz
Operating Input Voltage Range	100-277VAC, 50 Hz
Input Current	0.03 A Max.
Input Power	6W Max.
Power Factor	>0.85
THD	<60%
Efficiency	>75%
Driver Type	Constant Current
Output Current	250mA \pm 7%
Output Voltage Range	09-18VDC
Output Power	4.5W
Number of Output Channels	1 Channel
Dimming Controller Type/Dimming Range	NA
RFI/EMI	NA
Output Type	SELV Equivalent
Ambient Operating Temperature Range	-10°C to 50°C
Max. Case Temperature	65°C
Sound Rating	NA
Input Surge Protection	Line-Neutral 3kV DM
Protections	Input Over Current : NON-Resettable
	Input Over Voltage : 320VAC Operation for 48Hrs, 360VAC Operation for 2Hrs
	Input Under Voltage : NA
	Output Short Circuit : Auto Recovery (HICCUP Mode)
	Output Open Circuit : Auto Recovery (HICCUP Mode)
	Output to ground short : YES
	Output Overload : YES
Service Life	Over Temperature : NA
	50,000 hours @ Tc Max
Approvals / Class	Suitable for Dry Locations
Warranty	3 years
Weight	0.08 Kg

Note : All Performance Specified at Rated Voltage and Full Load. Output Current Tolerance : \pm 7%
Recommended to be used only for Indoor Application.

Figure 1

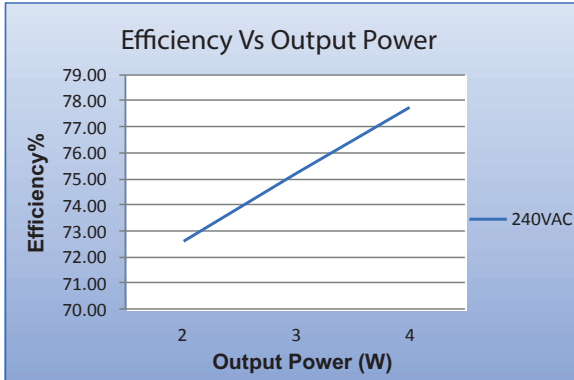

Figure 2

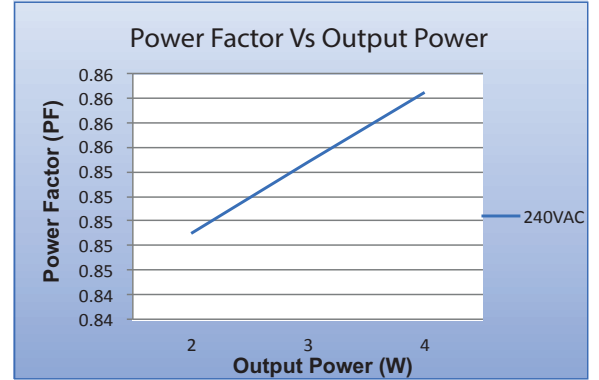

Figure 3

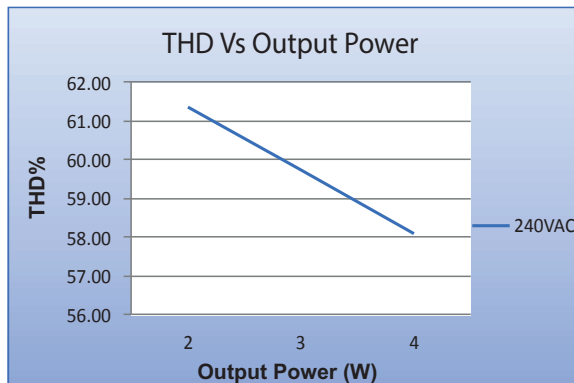

Figure 4

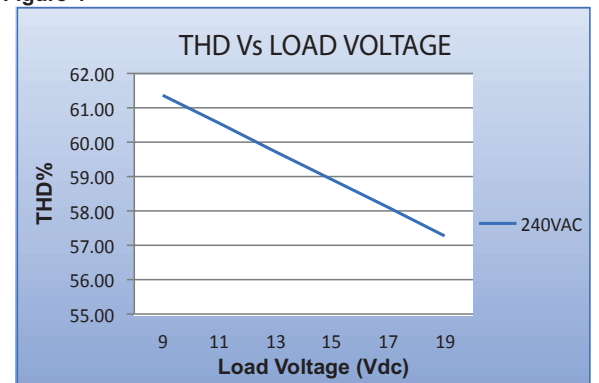
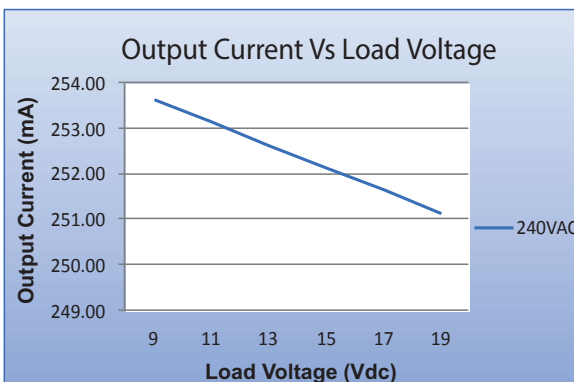
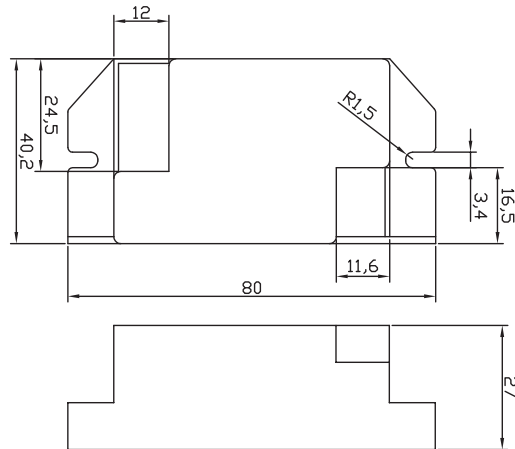

Figure 5



Mechanical Data



Note : All Dimensions are in mm.

Tolerance=±0.5mm

Wiring Diagrams



INPUT SIDE
WHITE CONNECTOR

OUTPUT SIDE
GREY CONNECTOR

Installation Instructions:

Connect Wires as per details given on the Driver Screen. Keep proper ventilation around the LED Driver and do not stack any object on it. Also a 10-15 cm clearance must be kept when the adjacent device is a heat source. Do not exceed the declared Hot spot temperature(T_c max) under any circumstances.