

FIREHORSE

FULHAM



City of Chicago Approved Exit Lighting & Signage



- Designed to strict Chicago specifications
- Adjustable lamp heads for high-lumen emergency illumination
- Heavy duty, 20-gauge steel construction for extreme durability
- Easy to install, very low maintenance
- Indoor / Damp location rated

When the lights go out, people don't think about lighting technology — they just want to get to safety. Fulham's Chicago-approved exit signs and emergency lights are engineered to provide reliable performance when you need them most.



FHCH10

Model Number	Description
FHCH10	6V, 24W, sealed lead acid battery, two lamp heads

Steel emergency light designed for new construction or retrofit applications. Two fully adjustable heads, push-to-test button, and universal mounting pattern knockout. Ideal for wall-mounted applications in stores, offices, hospitals and schools.

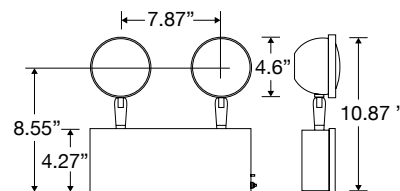

FHCH21

Series	# of Faces	Directional	Operation
FHCH21	S = Single D = Dual	NA = No Arrow DA = Double Arrow LA = Left Arrow RA = Right Arrow	AC = AC Only EM = Battery Back Up
Additional/Replacement Faceplates			
FHCHGONA = No Arrow FHCHGORA = Right Arrow FHCHGOLA = Left Arrow FHCHGODA = Double Arrow		FHCHGOST = Stairs FHCHGOSTRA = Stairs Right Arrow FHCHGOSTLA = Stairs Left Arrow	

Heavy duty, 20-gauge steel exit sign. Heat tempered, impact resistant glass lens. Multiple faceplate options. Ideal for ceiling- or wall-mounted applications in schools, offices, retail and hospitals.

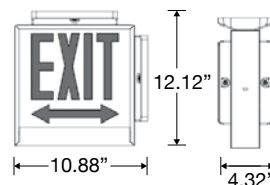

• Sample model number

FHCH21SLAAC: FHCH21 exit sign, single face with left arrow, AC operation only

FULHAM www.fulham.com

North America • China • Europe • India • Latin America

Fulham Headquarters: 12705 S. Van Ness Avenue, Hawthorne, CA 90250 Tel: +1 (323) 599-5000 Fax: +1 (323) 754-9060 • order@fulham.com

All trademarks are the property of their respective owners | ©Fulham Co. Inc., 2018 | REV: NOV18