



Features

- Input and output non-isolated
- Support DALI-2+pushDIM dimming mode
- Suitable for emergency lighting acc. to EN 50172
- 16-level current output can be realized by DIP-switch
- Soft dimming and flicker-free at any brightness, meets the new requirements of ErP certification
- Using HPC patented technology, at any dimming level, the brightness of the luminaries is the same
- Dimming range 3~100%, output current accuracy 5%
- Standby power input < 0.5W, meets the requirements of ErP certification
- High PF, high efficiency, low THD
- Suitable for built-in use of Class I lamps
- Passed CE, DALI-2 certifications
- IP20 protection grade, indoor use
- Nominal life-time up to 100,000 h
- 5 years warranty

Interfaces

- DALI-2(DALI-2 DT6)

Functions

- Support central emergency application (dimming normal in DC input)
- Support self-contained emergency application
- Protective features (short-circuit, no-load protection, overload protection)

Suitable for lights

- Suitable for luminaries with built-in driver such as track light
- Not suitable for luminaries with external drivers

Typical applications

- LED indoor lighting
- LED office lighting
- LED commercial lighting

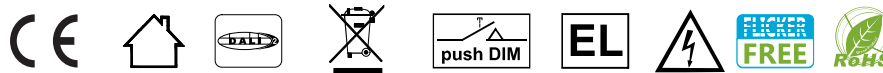



T1A1240080S-100EE-NI

SPECIFICATIONS



- Dimmable Constant Current LED Driver
- Multiple current selection through dip switch.
- Output Current: 250- 800mA
- Flicker Free: O/P Ripple current < 10%
- Output Wattage : 100W Max
- Output voltage range of 54-125/133/142/153/166/181/200VDC
- Linear CRCA Cabinet
- Suitable For Dry Locations
- Application:
 - Suitable for Linear fixture for Office, Education, Storage area and Retail

General Specifications

Rated Input Voltage	200-240VAC,200-240VDC,0/50/60Hz
Operating Input Voltage Range	180-264VAC,180-264VDC
Input Current	≤0.53 (Rated input voltage)
Input Power	107W
Power Factor	PF≥0.95 (230V AC & Full load),DF>0.98 (230V AC & Full load)
THD	≤7% (230V AC & Full Load)
Efficiency (Typical)	≥93%(230V AC & Full Load)
Driver Type	Constant Current DALI-2
Output Current	250mA,275mA,300mA,325mA,350mA,375mA,400mA,425mA,450mA,500mA @54-200VDC, 550mA@54-181VDC,600mA@54-166VDC,650mA@54-153VDC,700mA@54-142VDC, 750mA@54-133VDC,800mA@54-125VDC ± 5% * Refer DIP switch Table for O/P current selection.
Output Voltage Range	54-125/133/142/153/166/181/200Vdc
No Load Output Volatge	320VDC
Output Power	100W Max
Number of Output Channels	1 Channel
Class	Class I
Dimming Controller Type/Dimming Range	DALI 2.0,3%-100%
Ambient Operating Temperature Range	-20°C to 50°C
Max. Case Temperature	90°C
Input Surge Protection	2KV/2KV
Protections	Input Over Current : Non Resettable (Fuse) Output Short Circuit : Auto Recovery (HICCUP Mode) Output Open Circuit : Auto Recovery (HICCUP Mode) Output Overload : YES Over Temperature : Auto Recovery (HICCUP Mode)
Certification and Standards	EN61347-1, EN61347-2-13, En62384 EN55015, EN61000-3-2, EN61000-3-3, EN61000-4-2,3,4,5,6,8,11, EN61547 EN62386-101(DALI-2), EN62386-102(DALI-2),, EN62386-207(DALI-2) IEC 62386-101, IEC 62386-102, IEC 62386-107
Withstand Voltage	I/P-FG:1750Vac, I/P DALI:1500Vac
Leakage Current	<0.7mA @ 240Vac
Isolation resistance	I/P-O/P:100MΩ / 500Vdc / 25°C / 70% RH
Life	50,000 Hours @ 80°C
Approvals / Class	SELV Equivalent
Warranty	5 Years
Weight	0.277 Kg

Note : Suitable for Indoor application only

Fulham extends a limited warranty only to the original purchaser or to the first user for a period of **05 years @ Tc 80°C** from the date of manufacture when properly installed and operated under normal conditions of use. For complete terms and conditions, please reference the Fulham Product Catalog (www.fulham.com). Due to a program of continuous improvement, Fulham reserves the right to make modifications or variations in design or construction to the equipment described. © Fulham Company Limited, All Rights Reserved.

DIP-switch & output current

Pin(w) typ.	Output			1	2	3	4
	Prated(w)	Irated(mA)	Voltage(Vdc)				
53.76	50.00	250	54-200	ON	ON	ON	ON
59.14	55.00	275	54-200	-	ON	ON	ON
64.52	60.00	300	54-200	ON	-	ON	ON
69.89	65.00	325	54-200	-	-	ON	ON
75.27	70.00	350	54-200	ON	ON	-	ON
80.65	75.00	375	54-200	-	ON	-	ON
85.56	80.00	400	54-200	ON	-	-	ON
90.91	85.00	425	54-200	-	-	-	ON
96.26	90.00	450	54-200	ON	ON	ON	-
107.0	100.0	500	54-200	-	ON	ON	-
106.5	99.55	550	54-181	ON	-	ON	-
106.5	99.60	600	54-166	-	-	ON	-
106.4	99.45	650	54-153	ON	ON	-	-
106.3	99.40	700	54-142	-	ON	-	-
106.7	99.75	750	54-133	ON	-	-	-
107.0	100.0	800	54-125	-	-	-	-

Remark: This current is factory default.

■ This Switch is off.

Electrical values

Efficiency vs. Load

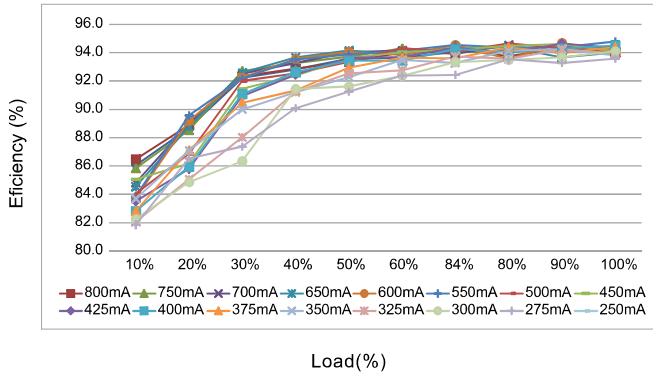

THD vs. Load

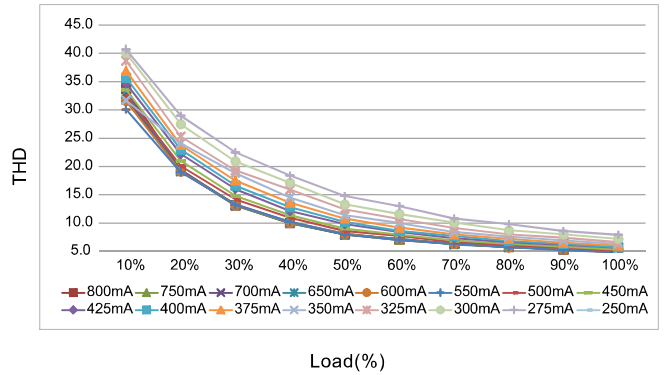

Power factor vs. Load

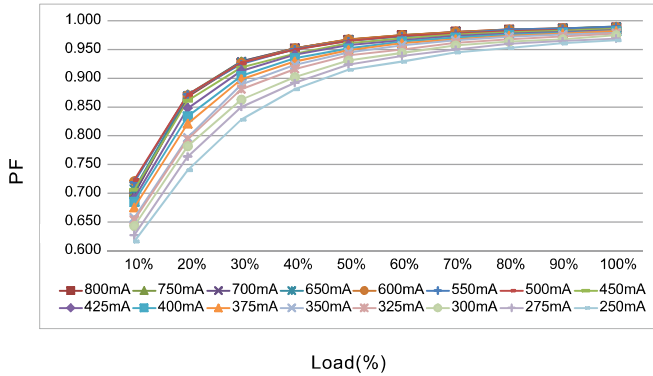

Life-time vs. case temperature

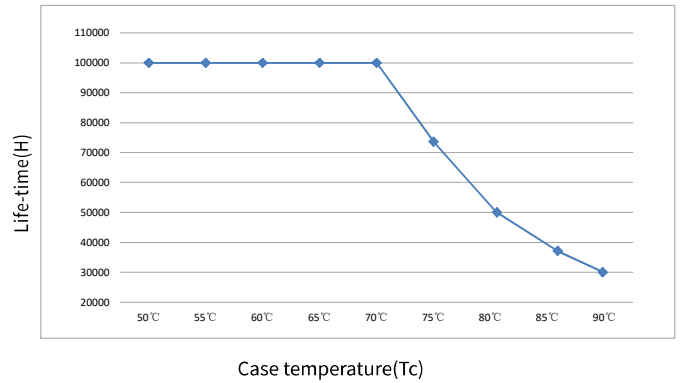

Fulham extends a limited warranty only to the original purchaser or to the first user for a period of **05 years @ Tc 80°C** from the date of manufacture when properly installed and operated under normal conditions of use. For complete terms and conditions, please reference the Fulham Product Catalog (www.fulham.com). Due to a program of continuous improvement, Fulham reserves the right to make modifications or variations in design or construction to the equipment described. © Fulham Company Limited, All Rights Reserved.

DALI dimming application

Wiring diagram

ACNACL DA DA

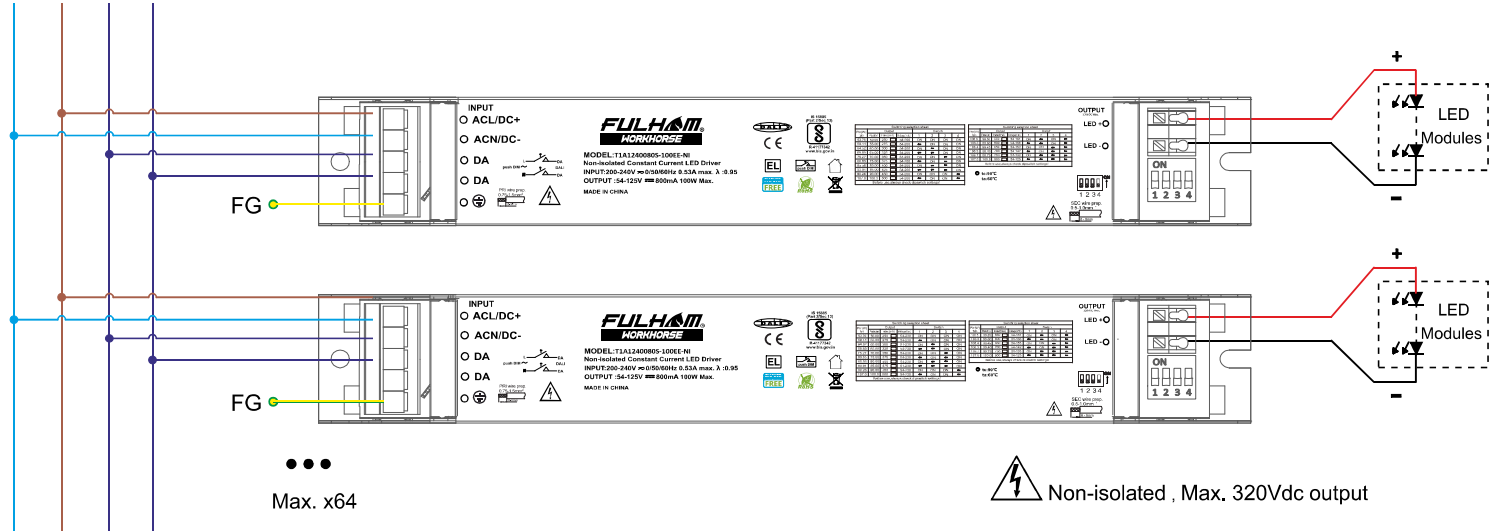

Activating DALI control mode

- After installation according to the wiring diagram of DALI control application, the driver will automatically switch to the DALI control mode after receiving any DALI command.

Remarks:

- Standard DALI control line voltage range: 9.5V to 22.5V, type 16V.
- The two DALI control lines polarity-reversible.
- Max. 64 DALI drivers per DALI control line.
- The maximum distance length of the DALI control line is 300m at 2 × 1.5mm².
- DALI bus can be wired together with any mains voltage cables, but separate wiring is recommended.

Wiring distance vs cable size

Cable size	Distance
2 × 0.50mm ²	max.100m
2 × 0.75mm ²	max.150m
2 × 1.00mm ²	max.200m
≥ 2 × 1.50mm ²	max.300m

Dimming curve

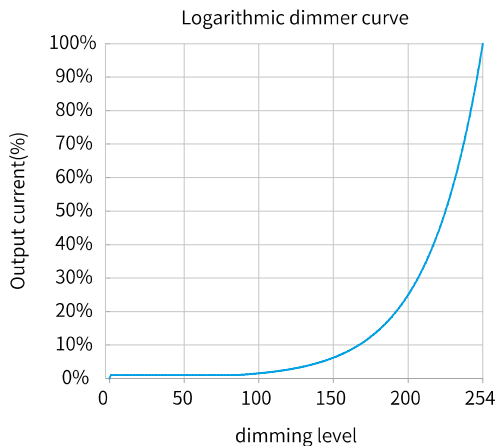

Remarks: The dimming curve can be selected by DALI configuration. The default is logarithmic dimming curve.

Fulham extends a limited warranty only to the original purchaser or to the first user for a period of **05 years @ Tc 80°C** from the date of manufacture when properly installed and operated under normal conditions of use. For complete terms and conditions, please reference the Fulham Product Catalog (www.fulham.com). Due to a program of continuous improvement, Fulham reserves the right to make modifications or variations in design or construction to the equipment described. © Fulham Company Limited, All Rights Reserved.

Mechanical Data:

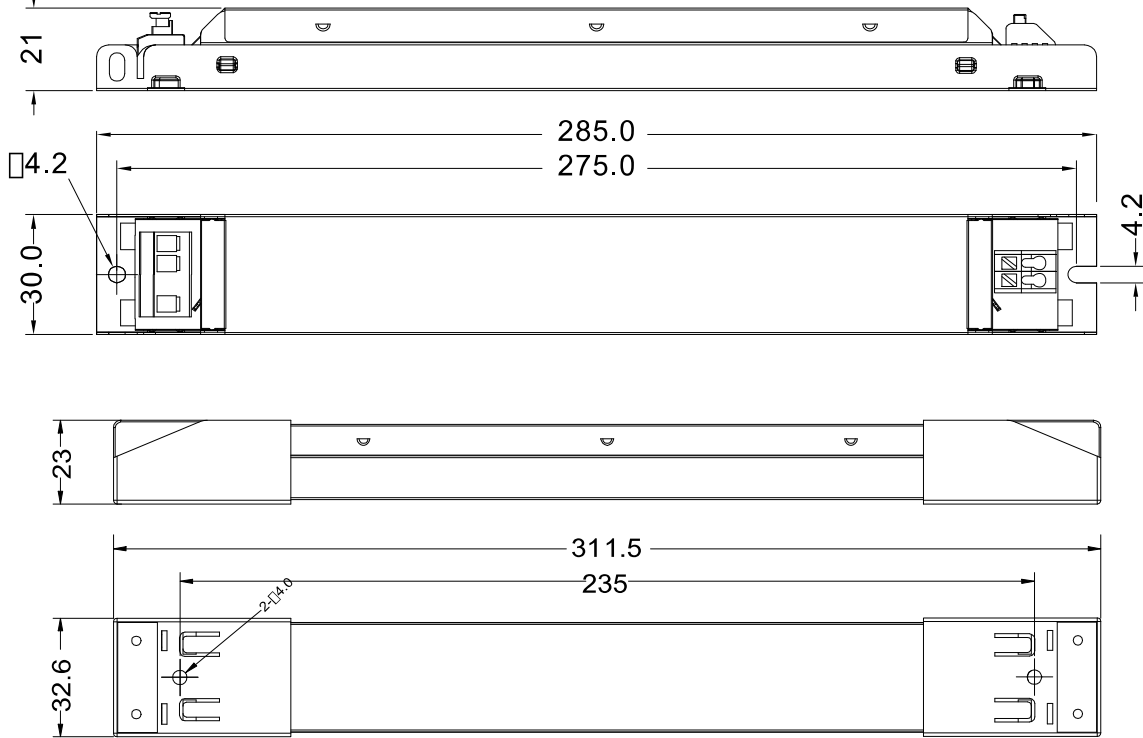

Cable Clamp Model No: [FH-CC003A](#)

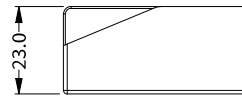
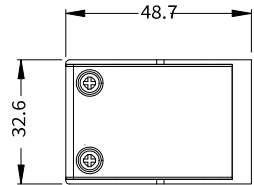

Tolerance=±0.5mm

Note : All Dimensions are in mm.

Packaging

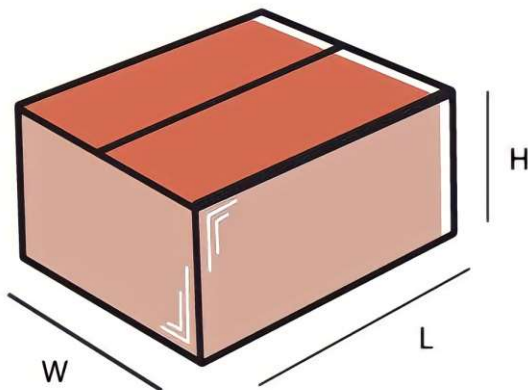

Master carton

OUTER DIMENSION		
L	W	H
355mm	285mm	170mm
Net Weight	Gross Weight	QUANTITY
8.02 Kg	9.32 Kg	35 Pcs

Installation Instructions:

Connect Wires as per details given on the Driver Screen. Keep proper ventilation around the LED Driver and do not stack any object on it. Also a 10-15 cm clearance must be kept when the adjacent device is a heat source. Do not exceed the declared Hot spot temperature(Tc max) under any circumstances.

Fulham extends a limited warranty only to the original purchaser or to the first user for a period of **05 years @ Tc 80°C** from the date of manufacture when properly installed and operated under normal conditions of use. For complete terms and conditions, please reference the Fulham Product Catalog (www.fulham.com). Due to a program of continuous improvement, Fulham reserves the right to make modifications or variations in design or construction to the equipment described. © Fulham Company Limited, All Rights Reserved.