

# IH3-UNV-272-T12HO

## Programmed Start Fluorescent Ballast

This Ballast Will Operate Following Lamps:



F48T8HO, F60T8HO,  
F72T8HO

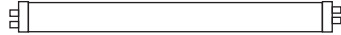

F48T10VHO, F60T10VHO,  
F72T10VHO, F96T12HO



F48T12HO, F60T12HO, F72T12HO  
F96T12VHO(215W)

## General Specifications

Input Voltage	120 - 277VAC, 50 / 60Hz
EMI / RFI Compliance	FCC Part 18-A (Non-Consumer)
Sound Rating	"A"
Ballast Type	Programmed Preheat Start
Voltage Transients	ANSI 62.41
Input Protection	Fuse
Output Protection	Deactivated Lamp Protection
Min. Operating Temp	-30°C (-22°F)
Max. Case Temp	70°C (158°F) See warranty note
Type	"CC"
Approvals Class	UL / cUL Listed, Class "P", 1 Outdoor, RoHS Compliant
Warranty	3 Years from the date of manufacture when properly installed.

## Electrical Data @120VAC

Lamp Wattage / Type	Lamps Operated	Input Wattage	Line Current	Power Factor	Ballast Factor	Efficacy Factor	THD	Current Crest Factor
F48T8HO	1	55	0.46	>0.9	1.17	2.15	<10%	<1.7
F60T8HO	1	66	0.55	>0.9	1.16	1.75	<10%	<1.7
F72T8HO	1	81	0.68	>0.9	1.16	1.44	<10%	<1.7
F48T12HO	1	55	0.47	>0.9	0.89	1.61	<10%	<1.7
F60T12HO	1	66	0.56	>0.9	0.89	1.35	<10%	<1.7
F72T12HO	1	74	0.62	>0.9	0.88	1.19	<10%	<1.7
F96T12HO	1	93	0.78	>0.9	0.95	1.02	<10%	<1.7
F48T10VHO	1	61	0.51	>0.9	0.50	0.83	<10%	<1.7
F60T10VHO	1	72	0.60	>0.9	0.52	0.72	<10%	<1.7
F72T10VHO	1	82	0.69	>0.9	0.50	0.60	<10%	<1.7
F96T12VHO	1	102	0.85	>0.9	0.48	0.48	<10%	<1.7
F48T8HO	2	108	0.91	>0.9	1.17	1.09	<10%	<1.7
F60T8HO	2	131	1.10	>0.9	1.15	0.87	<10%	<1.7
F48T12HO	2	107	0.90	>0.9	0.89	0.83	<10%	<1.7
F60T12HO	2	130	1.09	>0.9	0.90	0.69	<10%	<1.7
F72T12HO	2	145	1.21	>0.9	0.88	0.61	<10%	<1.7
F48T10VHO	2	120	1.00	>0.9	0.50	0.42	<10%	<1.7
F60T10VHO	2	139	1.09	>0.9	0.51	0.37	<10%	<1.7

# IH3-UNV-272-T12HO

## Electrical Data @230VAC

Lamp Wattage / Type	Lamps Operated	Input Wattage	Line Current	Power Factor	Ballast Factor	Efficacy Factor	THD	Current Crest Factor
F48T8HO	1	54	0.24	>0.9	1.17	2.15	<10%	<1.7
F60T8HO	1	67	0.30	>0.9	1.18	1.76	<10%	<1.7
F72T8HO	1	80	0.35	>0.9	1.16	1.45	<10%	<1.7
F48T12HO	1	55	0.25	>0.9	0.89	1.61	<10%	<1.7
F60T12HO	1	66	0.30	>0.9	0.89	1.35	<10%	<1.7
F72T12HO	1	74	0.33	>0.9	0.89	1.21	<10%	<1.7
F96T12HO	1	92	0.40	>0.9	0.92	1.01	<10%	<1.7
F48T10VHO	1	60	0.27	>0.9	0.50	0.83	<10%	<1.7
F60T10VHO	1	71	0.32	>0.9	0.52	0.72	<10%	<1.7
F72T10VHO	1	81	0.36	>0.9	0.49	0.61	<10%	<1.7
F96T12VHO	1	101	0.45	>0.9	0.49	0.48	<10%	<1.7
F48T8HO	2	107	0.47	>0.9	1.17	1.10	<10%	<1.7
F60T8HO	2	130	0.57	>0.9	1.17	0.90	<10%	<1.7
F48T12HO	2	105	0.46	>0.9	0.89	0.85	<10%	<1.7
F60T12HO	2	127	0.56	>0.9	0.90	0.70	<10%	<1.7
F72T12HO	2	141	0.62	>0.9	0.87	0.62	<10%	<1.7
F48T10VHO	2	118	0.52	>0.9	0.50	0.43	<10%	<1.7
F60T10VHO	2	136	0.59	>0.9	0.51	0.38	<10%	<1.7

## Electrical Data @277VAC

Lamp Wattage / Type	Lamps Operated	Input Wattage	Line Current	Power Factor	Ballast Factor	Efficacy Factor	THD	Current Crest Factor
F48T8HO	1	54	0.21	>0.9	1.16	2.14	<10%	<1.7
F60T8HO	1	67	0.25	>0.9	1.18	1.77	<10%	<1.7
F72T8HO	1	80	0.30	>0.9	1.16	1.45	<10%	<1.7
F48T12HO	1	56	0.21	>0.9	0.89	1.61	<10%	<1.7
F60T12HO	1	66	0.25	>0.9	0.90	1.35	<10%	<1.7
F72T12HO	1	74	0.28	>0.9	0.89	1.20	<10%	<1.7
F96T12HO	1	92	0.34	>0.9	0.92	1.01	<10%	<1.7
F48T10VHO	1	60	0.23	>0.9	0.50	0.83	<10%	<1.7
F60T10VHO	1	71	0.27	>0.9	0.52	0.72	<10%	<1.7
F72T10VHO	1	80	0.30	>0.9	0.49	0.61	<10%	<1.7
F96T12VHO	1	101	0.38	>0.9	0.49	0.48	<10%	<1.7
F48T8HO	2	106	0.39	>0.9	1.17	1.10	<10%	<1.7
F60T8HO	2	131	0.48	>0.9	1.17	0.90	<10%	<1.7
F48T12HO	2	105	0.39	>0.9	0.90	0.85	<10%	<1.7
F60T12HO	2	127	0.47	>0.9	0.89	0.70	<10%	<1.7
F72T12HO	2	141	0.52	>0.9	0.87	0.62	<10%	<1.7
F48T10VHO	2	118	0.43	>0.9	0.50	0.43	<10%	<1.7
F60T10VHO	2	135	0.50	>0.9	0.51	0.38	<10%	<1.7

# IH3-UNV-272-T12HO

## Mechanical Data

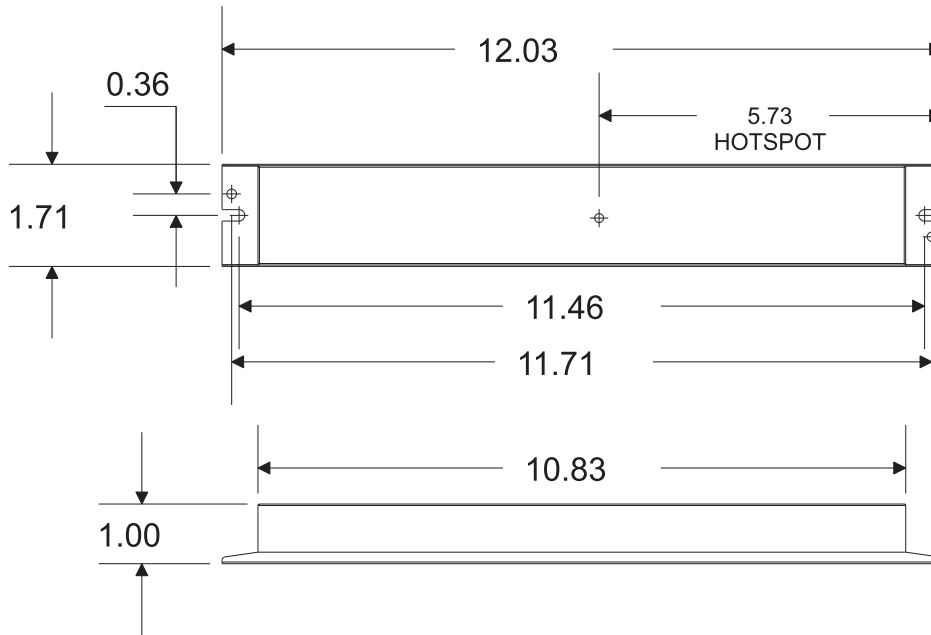

## Wiring Diagram

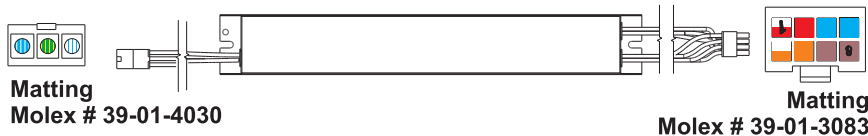

Wire Color	Length (Inches)
White/Blue	7" ±1"
Green/Yellow	7" ±1"
Blue/White	7" ±1"

Wire Color	Length (Inches)
Orange/White	7" ±1"
Orange	7" ±1"
Brown	7" ±1"
Brown	7" ±1"
Red/White	7" ±1"
Red	7" ±1"
Blue	7" ±1"
Blue	7" ±1"

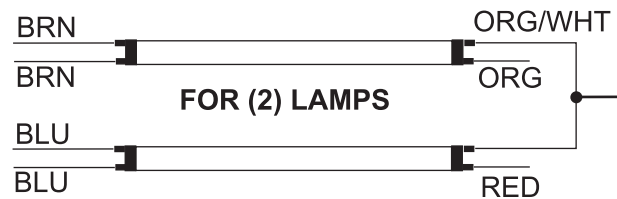
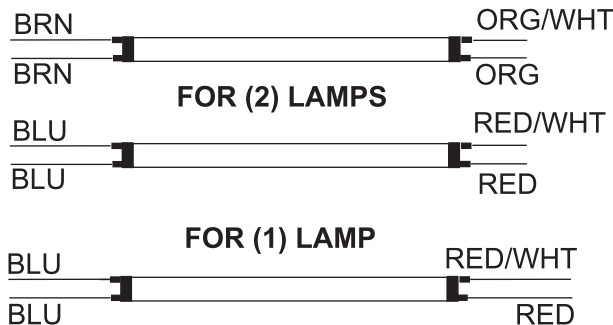

**NOTE : FOR 7 WIRES SYSTEM, CAP RED/WHT WIRE**

**NOTE : This Ballast Case Must Be Grounded**